



JVC

LT-32DE9BJ
LT-26DE9BJ

LCD FLAT TV

INSTRUCTIONS

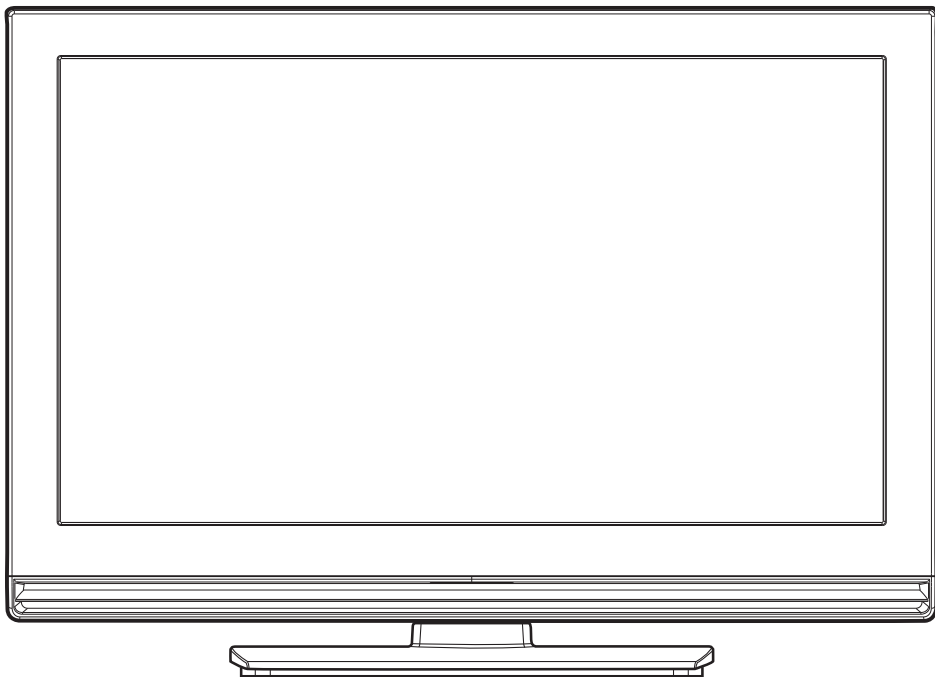

HD
ready
HDMI[™]
HIGH DEFINITION MULTIMEDIA INTERFACE
HDD PVR

DVB[®]
Digital Video
Broadcasting

Trade Mark of the DVB Digital Video Broadcasting
Project (1991 to 1996) Number : 5229: LT-32DE9BJ
5230: LT-26DE9BJ

Dear Customer,

This apparatus is in conformance with the valid European directives and standards regarding electromagnetic compatibility and electrical safety.

European representative of Victor Company of Japan, Limited is:

JVC Technical Services Europe GmbH

Postfach 10 05 04

61145 Friedberg

Germany

Information for Users on Disposal of Old Equipment



Attention:

This symbol is only valid in the European Union.

[European Union]

This symbol indicates that the electrical and electronic equipment should not be disposed as general household waste at its end-of-life. Instead, the product should be handed over to the applicable collection point for the recycling of electrical and electronic equipment for proper treatment, recovery and recycling in accordance with your national legislation.

By disposing of this product correctly, you will help to conserve natural resources and will help prevent potential negative effects on the environment and human health which could otherwise be caused by inappropriate waste handling of this product. For more information about collection point and recycling of this product, please contact your local municipal office, your household waste disposal service or the shop where you purchased the product.

Penalties may be applicable for incorrect disposal of this waste, in accordance with national legislation.

(Business users)



If you wish to dispose of this product, please visit our web page www.jvc-europe.com to obtain information about the take-back of the product.

[Other Countries outside the European Union]

If you wish to dispose of this product, please do so in accordance with applicable national legislation or other rules in your country for the treatment of old electrical and electronic equipment.

NOTICE

Read this manual carefully and make sure you understand the instructions provided. For your safety, check what the result of each action will be.

	<p>To reduce the risk of electric shock, do not remove cover (or back). No user serviceable parts inside. Refer servicing to qualified service personnel. Indicates a situation which, if not avoided, could damage the equipment or other apparatus.</p>
	<p>This symbol indicates dangerous voltage inside the TV that presents a risk of electric shock or personal injury. Indicates a hazardous situation which, if not avoided, could result in serious injury.</p>
	<p>This symbol indicates important instructions accompanying the TV.</p>

Copyright (© 2008 Victor Company of Japan, Limited)

Not to be copied, used or translated in part or whole without JVC's prior consent in writing except approval of ownership of copyright and copyright law.

Warranty

The information in this document is subject to change without notice. JVC does not have any responsibility for direct, indirect, accidental and other damage caused by the use of the information contained in this manual.

Trademarks

VIACCESS™ is a trademark of France Telecom.

CryptoWorks™ is a trademark of Philips Electronics N.V.

Irdeto is a trademark of Mindport BV.

Nagravision is a registered trademark of KUDELSKI S.A.

Conax is a trademark of Telenor Conax AS.

Thank you for purchasing a JVC TV. Please read this user manual carefully in order to safely install, use and maintain the TV at maximum performance. Keep this user manual next to your TV to ensure the best performance possible.

Freeview Playback explained:

Your TV is now compatible with Freeview Playback Group 2 requirements.

- **Accurate recording** by auto tracking
The start and end times of scheduled recordings will track the signal, meaning the recording will start and stop at the times sent by the broadcasters. If a programme starts early or runs late, the record time will automatically be adjusted to record the whole programme. (Refer to p.24, 42)
- **Series Link**
If a programme you wish to record is in a series, you can record the whole series. If the programme changes to a different day or time, the TV will track these changes and still record the programme. (Refer to p.24, 25, 42)
- **Alternate Instances**
If a scheduled recording(s) overlap with other programmes set to record, you will be given the option to record one of the programmes later that, day or week, on the same channel or a different channel.
- **Split Recordings**
If a programme has two parts split by another entry in the Guide (e.g. a film divided in to two parts by a News programme), you will be given the option to set both parts to record. (Refer to p.24, 25, 42)

NOTE: The above Freeview Playback features are available on channels where the correct and accurate data is being broadcast. Some channels may not support all services.

GENERAL SAFETY PRECAUTIONS

Power

- Plug the power cord into the correct power outlet. An unstable connection may cause fire.
- Do not use damaged power cords or plugs, or use a loose wall outlet. This may cause electrical shock or fire.
- Do never touch the power cord with wet hands. This may cause electrical shock.
- Do not use multiple devices with one outlet. Overheating the outlet may cause fire.
- Do not bend or pull out the power cord using force, nor place heavy objects over it. This may cause electrical shock or fire.
- Make sure you pull out the power cord holding the plug itself. An internal disconnection may cause fire.
- When removing the product, turn off the power and pull out the plug from the power outlet. Also make sure other devices including the antenna or the connectors are removed from the outlets before relocating the product. Otherwise you may suffer electrical shock or fire due to a damaged power cord.
- The mains plug shall remain readily operable.
- Plug as disconnection device shall remain to be readily approached by user.
- Make enough room for inserting and removing the power plug. Place the TV as close to the outlet as possible.
- Even if the TV's power lamp is unlit, the main power supply is not cut off unless the power cord is unplugged. The main power supply is not cut off unless the power cord is unplugged. The main power supply for this TV is controlled by inserting or removing the power plug.
- If you do not use this TV for a long period of time, be sure to disconnect the power plug from the AC outlet.
- This is a class 1 product so it shall be connected to a Main Socket outlet with a protective earthing connections.

Installation

- Keep the product away from any heating devices. Placing it close to a heating device may cause fire.
- Keep the power cord away from any heating devices. A melted coating may cause fire or electrical shock.
- Place the antenna as far away as possible from any high-voltage cables. Touching the high voltage wiring may cause fire or electrical shock.
- Do not install the product in oily, smoky or humid (or exposed to rain/water) places or automobiles. This may cause fire.
- The connection between the external antenna and the internal wiring should be turned inside to avoid any inflow of rain. Exposing the LCD to water (rain) will cause electrical shock or fire.
- Do not use the product in humid places. Humidity will shorten the life of the product and may cause an electrical shortage or fire.
- Do not use the product in places with low temperatures (below 5°C).
- Avoid installing the product in poorly ventilated places. Internal overheating may cause an electrical shortage and fire.
- Be sure not to cover the ventilator (with a table-cloth or curtain, etc.). Internal overheating may cause an electrical shortage and fire.
- Do not install the product in an unstable place or on a small stand. The product may cause serious injury, if it falls on somebody (especially children). Install it on an even, stable place as it is front-heavy.
- Do not install the product on the floor. Someone (especially children) may trip over it.

GENERAL SAFETY PRECAUTIONS

Usage

- Unplug the product from the wall outlet and do not touch the antenna during a thunderstorm. This will prevent damage to the unit due to lightning and power-surges.
- Keep dust or water away from the pins or touching points of the power plug. This will prevent electrical shock or fire.
- Keep children from climbing over the product. The device may cause serious injury or death if it falls on them.
- Do not place anything over the product that children may try to reach. The device may cause serious injury or death if it falls on them.
- When removing the battery from the product, keep it out of children's reach. If a child swallows a battery, consult a doctor immediately.
- Use only specified batteries and do not use an old battery along with a new one. Align the batteries according to the correct polarity (+ or -). Aligning them incorrectly may cause an internal explosion or a leakage of the internal liquid, leading to electrical shock, physical damage or pollution of the surroundings.
- Do not insert any metal or a flammable object or an alien substance into the ventilator, the AV input terminals or the slot for the CAM (Conditional Access Module). This may cause damage to the product and reduce its life span.
- Do not disassemble, repair or reconstruct the product at your discretion. This may cause electrical shock or fire. Contact your local customer support.
- Keep the product away from inflammable sprayers or ignitable objects. Exposure to these may cause explosion or fire.
- Do not place water-pots, flower vases, beverage cans, small metals or heavy objects over the product. Contact of these contents with the product may cause electrical shock or fire, while any falling of the product may cause injury.
- Do not place naked flame source, such as lighted candles over the product. It may cause a fire.
- If the product breaks down, turn off the power and unplug it from the outlet before contacting Customer Support. This will protect you from electrical shock or fire.
- When you notice something strange like an odd noise, smell something burning or see smoke, unplug the power cord and contact your local Customer Support. Do this to avoid electrical shock or fire.
- Do not use sharp tools such as a pin or a pencil near the TV, as they may scratch the LCD surface.
- Do not use a solvent, such as benzene, to clean the TV, as it will damage the LCD surface.
- Do not move the TV or turn the power off suddenly while the hard disk drive is running.
- The company shall not be liable for any corruption of data on the hard disk drive caused by the carelessness or misuse of users.
- Do not separate the hard disk drive from the main body. Contact your local Customer Support when you want to change the hard disk drive.

Cleaning

- Unplug the power cord before cleaning the product. This may cause electrical shock or fire.
- Do not sprinkle water on the product. This may cause electrical shock or fire.
- Use only a soft dry cloth as the surface is weak on scratch. Do not use chemicals like wax, benzene, alcohol, thinners, aroma, lubricator or cleanser.

Handling the glossy finish of the TV

- Be careful when handling the glossy finish of the TV. The glossy finish of the TV scratches easily.
- Protection films have been pasted onto the glossy finish of the TV to prevent scratches. Peel off the films after the TV has been placed properly.
- If the glossy finish gets dirty, clear the dust off the glossy finish first. Then wipe softly with a soft cloth. If you do not clear the dust first, or you wipe the glossy finish too hard the glossy finish may be scratched.

TABLE OF CONTENTS

PREPERATION

Front and Side Panel	-7
Rear and Side Panel	-9
Remote Control Buttons	-10
Connecting the Antenna	-12
Inserting a CAM (Conditional Access Module) (for the digital channels only)	-12

CONNECTING EXTERNAL DEVICES

Connecting the DVD or Set-Top Box	-13
Connecting the VCR	-14
Connecting the Camcorder or Game Console	-14
Connecting the Digital Audio System (In Digital TV Mode Only)	-15
Connecting Headphones	-15

INSTALLATION WIZARD

Wizard for Digital Channels (In Digital TV Mode Only)	-16
Wizard for Analog Channels (APS) (In Analog TV Mode Only)	-17

BASIC OPERATION

Turning on the TV	-18
Changing Channel	-18
Volume Control	-18
Displaying Information	-19
Displaying Channel List	-20
Digital Programme Features (In Digital TV Mode Only)	-21
Selecting the Main Input Source	-22
Setting the Aspect Ratio	-22
Displaying Teletext information	-23

PROGRAMME GUIDE (In Digital TV mode only)

Changing the Channel List Group	-24
Moving the Time Bar	-25
Reserving a Recording (Schedule)	-25
Finding a Programme	-26

MENU SETTINGS

Picture Settings	-27
Sound Settings	-27
Installation Settings (In Analog TV Mode Only)	-28
Feature Settings	-28
DTV Setup (In Digital TV Mode Only)	-30

ANALOG CHANNEL SETTINGS (In Analog TV mode only)

Automatic Search	-31
Manual Search	-32
Edit Channels	-32

DIGITAL CHANNEL SETTINGS (In Digital TV mode only)

Auto Search	-33
Manual Search	-34
Edit Channels	-34

RECORDING AND PLAYBACK (In Digital TV mode only)

Time Shifted Recording (TSR)	-35
Playback Control Buttons	-36
Instant Recording	-38
Descrambling and Re-recording	-38
Recording Schedule	-39
Programme Playback in the Play List	-40
Chase Play	-41
Editing Recorded Programmes	-42
HDD Control	-44
Recording's Start/End Time	-44

DTV CONFIGURATION (In Digital TV mode only)

Parental Control	-45
Language Setting	-45
Time Setting	-46
Miscellaneous Settings	-46

DTV SOFTWARE UPDATE (In Digital TV mode only)

Automatic Update	-47
Manual Update	-47
Regular Auto Update and Search Time	-48

APPENDIX

Menu Map	-49
Troubleshooting	-50
Error Message	-52
Specifications	-53

PREPERATION

Front and Side Panel

Here the shown illustration is LT-32DE9BJ model and may be somewhat different from your TV.

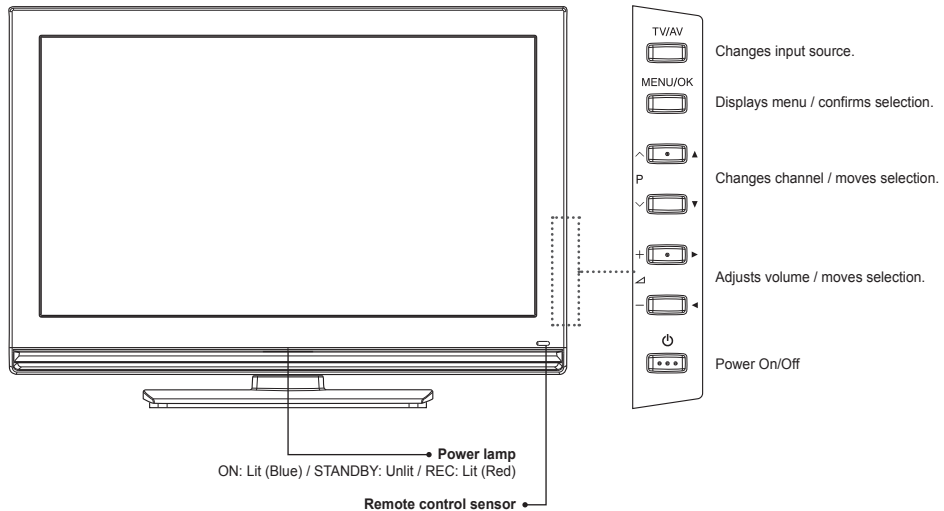

Accessories

Please check that the following accessories are included with your TV.

Note: Package contents may vary according to area.

- ✓ Remote control (RM-C2111B)
- ✓ AA batteries (X2)
- ✓ User's manual
- ✓ Power cord

Inserting Batteries

Insert two AA size batteries ensuring that the plus(+) and minus(-) signs of the batteries are correctly aligned.

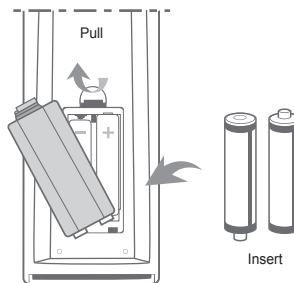

NOTE: Do not mix different battery types such as alkaline with manganese.

NOTE: Stand and screws are also included. For details, refer to page 8. (only for LT-32DE9BJ).

PREPERATION

When attaching the TV to the wall, use the optional JVC wall mounting unit (only for LT-32DE9BJ)

- Consult a qualified technician.
- See the included manual on mounting procedures.
- JVC assumes no responsibility for damage due to improper mounting.
- Mounting holes for wall mounting unit : M5 x 4, 200mm x 200mm
Depth of screw holes: 13.7mm from the surface of the TV

Installation requirements

To avoid overheating, ensure the unit has ample room.

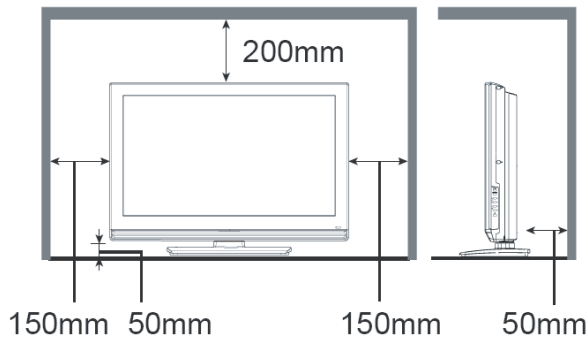

Stand Installation (only for LT-32DE9BJ)

Assemble the TV as shown.
Fix the 4 screws securely using the holes in the back of the TV.

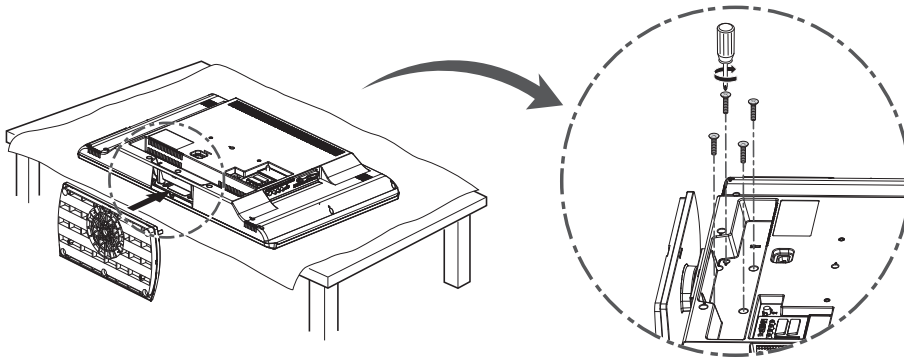

Note: To prevent scratches on the panel, lay a piece of soft cloth on an even platform and place the TV onto it.

PREPERATION

Rear and Side Panel

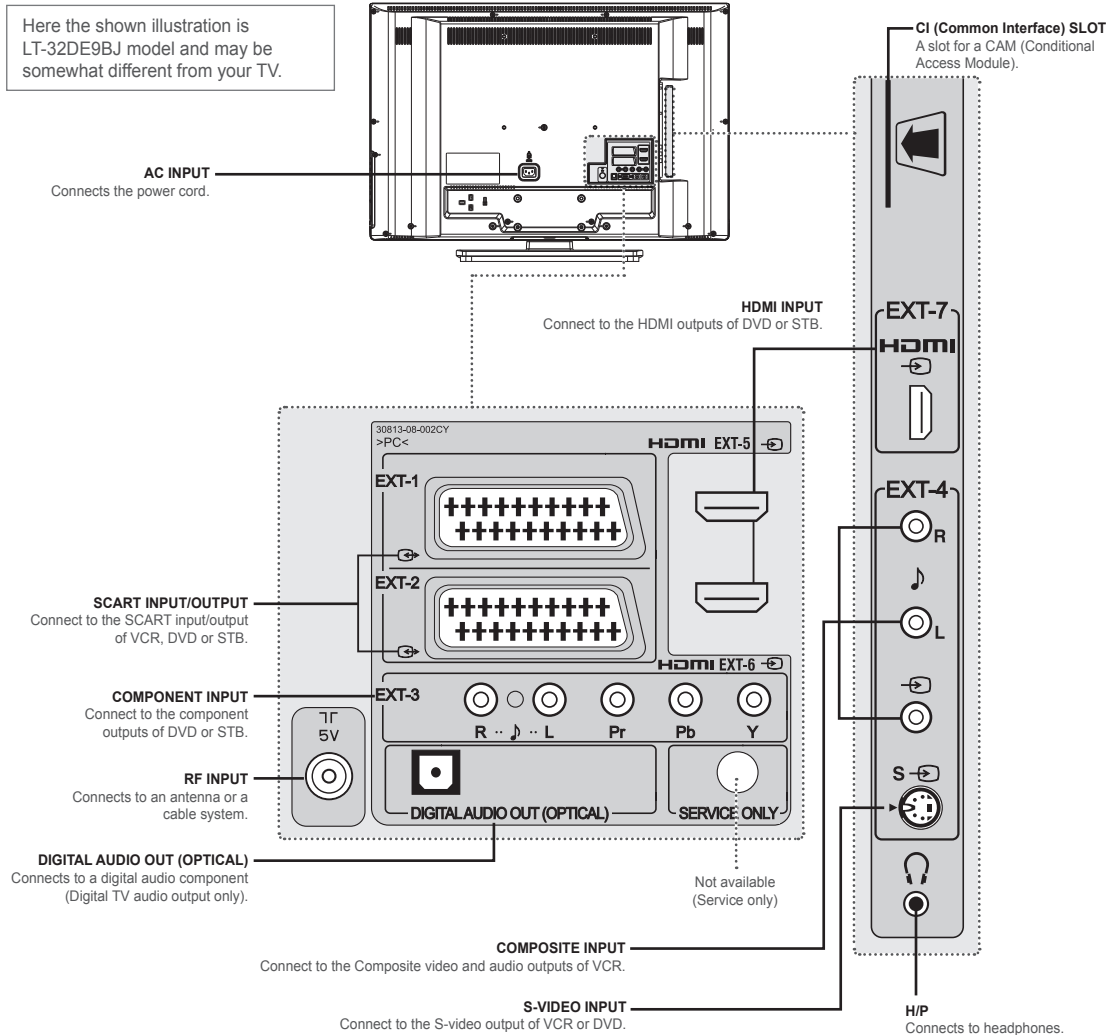

External AV Terminals by Model

	SCART Input/Output	COMPONENT Input	COMPOSITE Input	S-VIDEO Input	HDMI Input
LT-26DE9BJ	EXT-1, EXT-2	EXT-3	EXT-4	EXT-4S	EXT-5, EXT-6
LT-32DE9BJ	EXT-1, EXT-2	EXT-3	EXT-4	EXT-4S	EXT-5, EXT-6, EXT-7

Remote Control Buttons

⏻/⏻ (Power On/Off)
Switches between operation and standby modes.

AV
Changes input sources.

🔇 (MUTE)
Mutes the sound.

TV/DTV
Switches between digital TV and analog TV modes.

PIC MODE
Selects the picture mode.

🔊 I/II (DUAL SOUND)
Selects the sound mode (Stereo, Mono, etc.) in Analog TV input or the soundtrack list in Digital TV input.

🗨 (SUBTITLE)
Selects the subtitle language in Digital TV input.

TV/RADIO
Switches between digital TV and Radio modes.

SLEEP
Selects a preset time interval for switching the TV to standby mode automatically.

ZOOM
Select the aspect ratio.

Number Buttons
Enters the channel number for direct display. Used to enter digit numbers.



No function button

Coloured Buttons
Used for interactive applications in the EPG, Edit Channels and Teletext mode.

MENU
Displays the On Screen Display (OSD) menu.

BACK
Returns to the previous display.

OK/LIST
Confirms (save or enter) your choice in the On Screen Display (OSD) menu or displays the channel list.

Arrow (▲/▼/◀/▶) Buttons
Controls the selection in the On Screen Display (OSD) menu.

i (Information)
Displays information on the current channel or input.

GUIDE
Displays the Electronic Programme Guide (EPG) in Digital TV input.

PLAYLIST
Displays the recorded programme list.

SCHEDULE
Displays the reserved programme list.

P ▲ / ▼
Switches channels.

VOL +/-
Adjusts the volume.

PREPERATION

BOOKMARK ADD
Saves the current viewing position as a bookmark.

BOOKMARK JUMP
Displays the list of saved viewing positions.

A->B (A-B Repeat)
Plays back a specified block repeatedly.

TELETEXT Function Buttons

TEXT ON/OFF
Activates or deactivates the teletext service.

MIX
Overlaps the teletext with the broadcasting screen. Adjusts the opacity to the background in Teletext mode.

INDEX
Displays the teletext index page.

CANCEL
Displays the TV programme when searching for the new teletext page.

REVEAL
Shows the hidden information.

F.T/L (MODE)
Selects the teletext mode (LIST/FLOF)

SIZE
Displays the double-size letters.

HOLD
Holds the current teletext page not updating it.

SUBPAGE
Displays the available sub-page.

Playback Control Buttons (only in Digital TV input)

REPLAY
Jumps back 7 seconds (default value) and starts playing again in trick play mode.

SKIP
Skips watching the programme for 30 seconds (default value) forward.

SLOW
Plays the programme in slow motion mode.

STOP
Stops recording or playback and go to the live programme.

RECORD
Records programmes or sets time to end recording.

PLAY/PAUSE
Plays at normal speed or pauses the live programme.

FAST FORWARD
Fast forward at high speed. Each time you press this button the fast forwarding speed increases.

FAST REWIND
Rewinds at high speed. Each time you press this button the fast rewinding speed increases.

No function button

Connecting the Antenna

- 1 Connect the RF coaxial cable from an aerial or a cable TV to the **RF** jack on the rear of the TV.

NOTE

- For proper reception of signals, an external antenna is required. For best reception, an outdoor antenna is recommended.
- To improve the picture quality in a poor signal area, please purchase a signal amplifier and install properly.

Here the shown illustration is LT-32DE9BJ model and may be somewhat different from your TV.

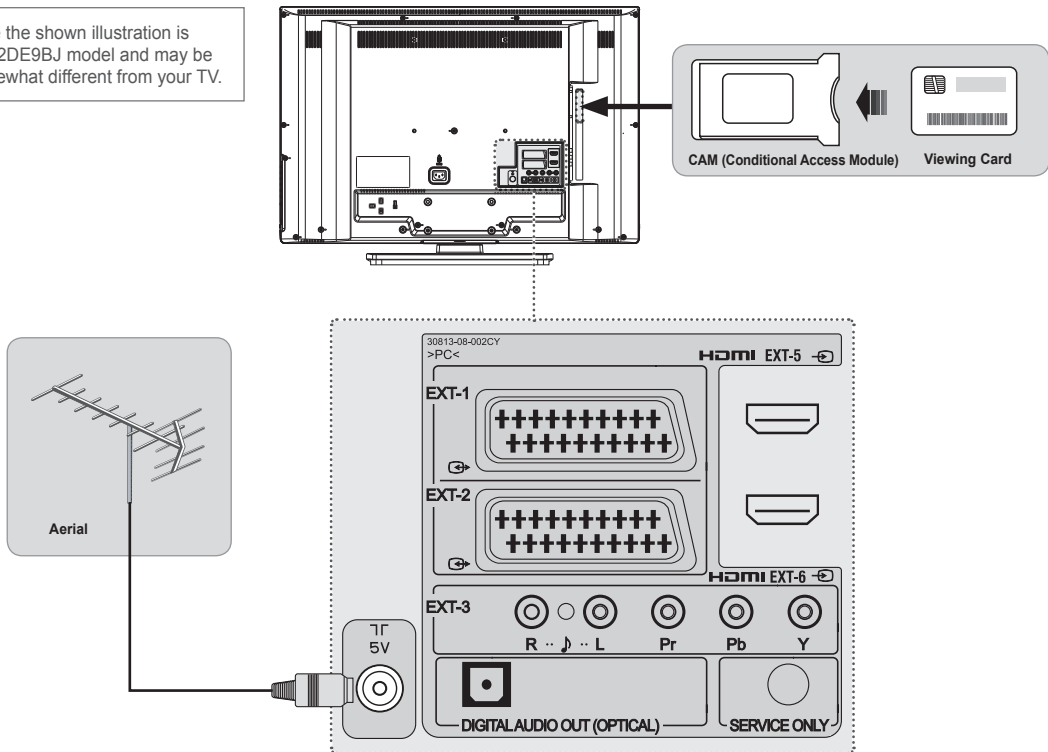

Inserting a CAM (Conditional Access Module)

(for the digital channels only)

CAM (Conditional Access Module) looks like a PC Card (called PCMCIA) for laptops. There are different kinds of CAM (Conditional Access Module) suitable for different coding systems.

- 1 Follow the instructions of the module and insert a Viewing Card into the CAM (Conditional Access Module).
- 2 Keep the CAM (Conditional Access Module) (with a Viewing Card) vertically.
- 3 Insert the CAM (Conditional Access Module) completely into the CI slot on the side of the TV.

NOTE: Ensure the Viewing Card or CAM (Conditional Access Module) is inserted in the right direction. Inserting in the wrong direction may cause damage to the Viewing Card or CAM (Conditional Access Module).

CONNECTING EXTERNAL DEVICES

Connecting the DVD or Set-Top Box

Here the shown illustration is LT-32DE9BJ model and may be somewhat different from your TV.

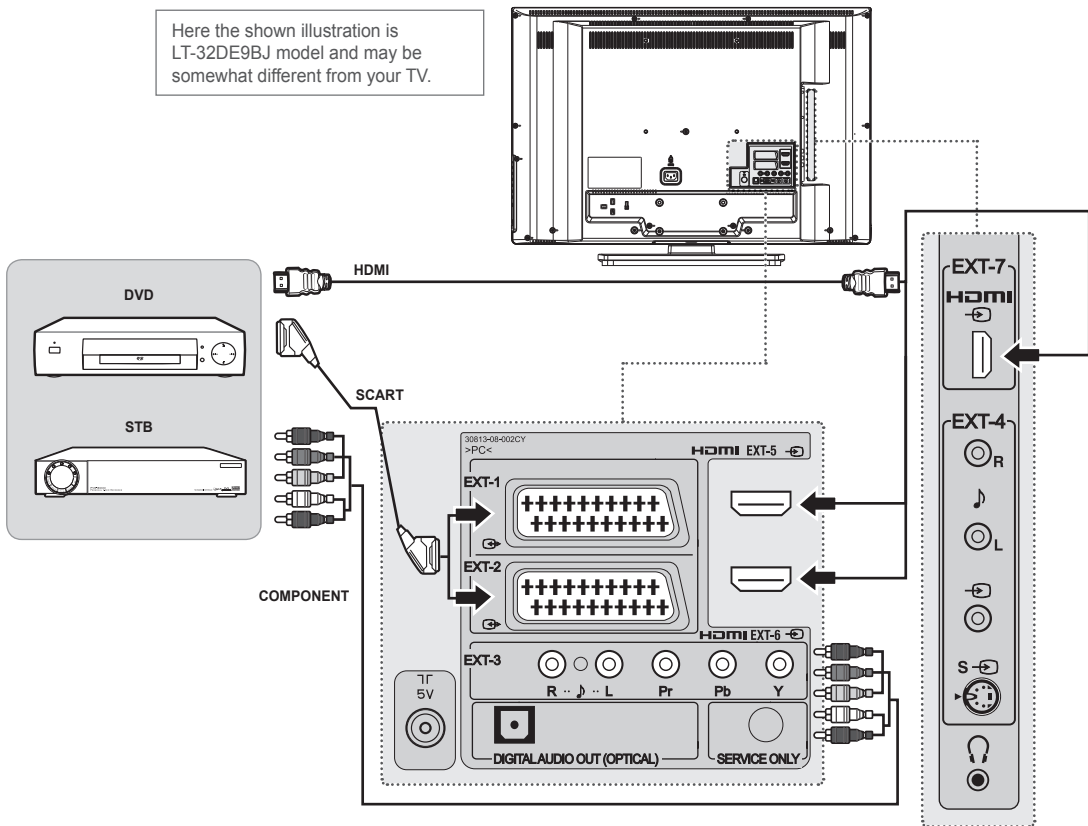

With a SCART cable

Connect the SCART cable between the SCART connector (**EXT-1** or **EXT-2**) on TV and the SCART connector of DVD or STB.

With a component cable

Connect the component video and audio cable between the component video and audio input connectors (**EXT-3**) on TV and the component video and audio output connectors of DVD or STB.

NOTE: Depending on the manufacturer, the Y/Pb/Pr jacks may be identified as Y/PB/PR, Y/B-Y/R-Y or Y/CB/CR.

With an HDMI cable

Connect the HDMI cable between the (**EXT-5**, **EXT-6** or **EXT-7**) on TV and the HDMI output connector of DVD or STB.

NOTE: All HDMI inputs support DVI video but only first HDMI input (**EXT-5**) supports DVI audio through component audio input (**EXT-3**).

	SCART Input/Output	COMPONENT Input	HDMI Input
LT-26DE9BJ	EXT-1, EXT-2	EXT-3	EXT-5, EXT-6
LT-32DE9BJ	EXT-1, EXT-2	EXT-3	EXT-5, EXT-6, EXT-7

Connecting the VCR

With a SCART cable

Connect the SCART cable between the SCART connector (**EXT-1** or **EXT-2**) on TV and the SCART connector of VCR.

With a composite cable

Connect the composite video and audio cable between the composite video and audio input connectors (**EXT-4**) on TV and the composite video and audio output connectors of VCR.

With a S-video cable

Connect the S-video and audio cable between the S-video and audio input connectors on TV (**EXT-4**) and the S-Video and audio output connectors of VCR.

NOTE: The composite video and S-Video share Audio-L/R in EXT-4 on side.

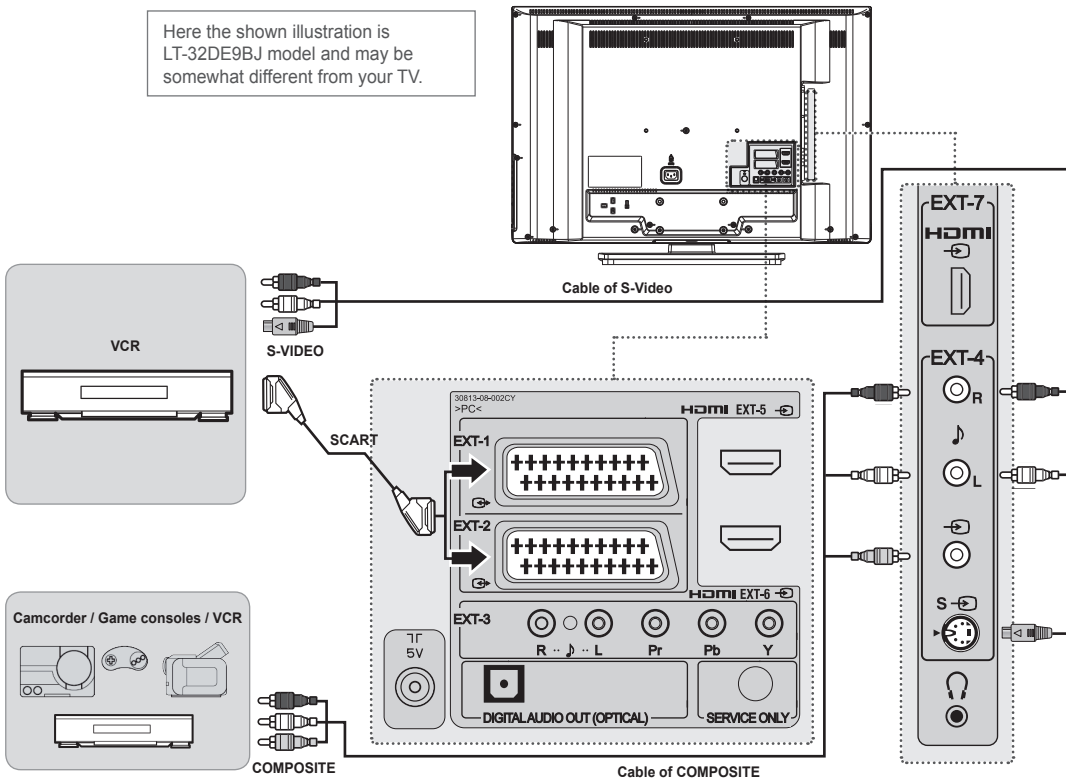

Connecting the Camcorder or Game Console

With a composite cable

Connect the composite video and audio cable between the composite video and audio input connectors (**EXT-4**) on TV and the composite video and audio output connectors of camcorder or game console.

	SCART Input/Output	COMPOSITE Input	S-VIDEO Input
LT-26DE9BJ	EXT-1, EXT-2	EXT-4	EXT-4S
LT-32DE9BJ	EXT-1, EXT-2	EXT-4	EXT-4S

Connecting the Digital Audio System (In Digital TV Mode Only)

DIGITAL AUDIO OUT (OPTICAL)

Connect the optical cable between the **DIGITAL AUDIO OUT (OPTICAL)** on TV and the composite optical audio input connector of digital audio system.

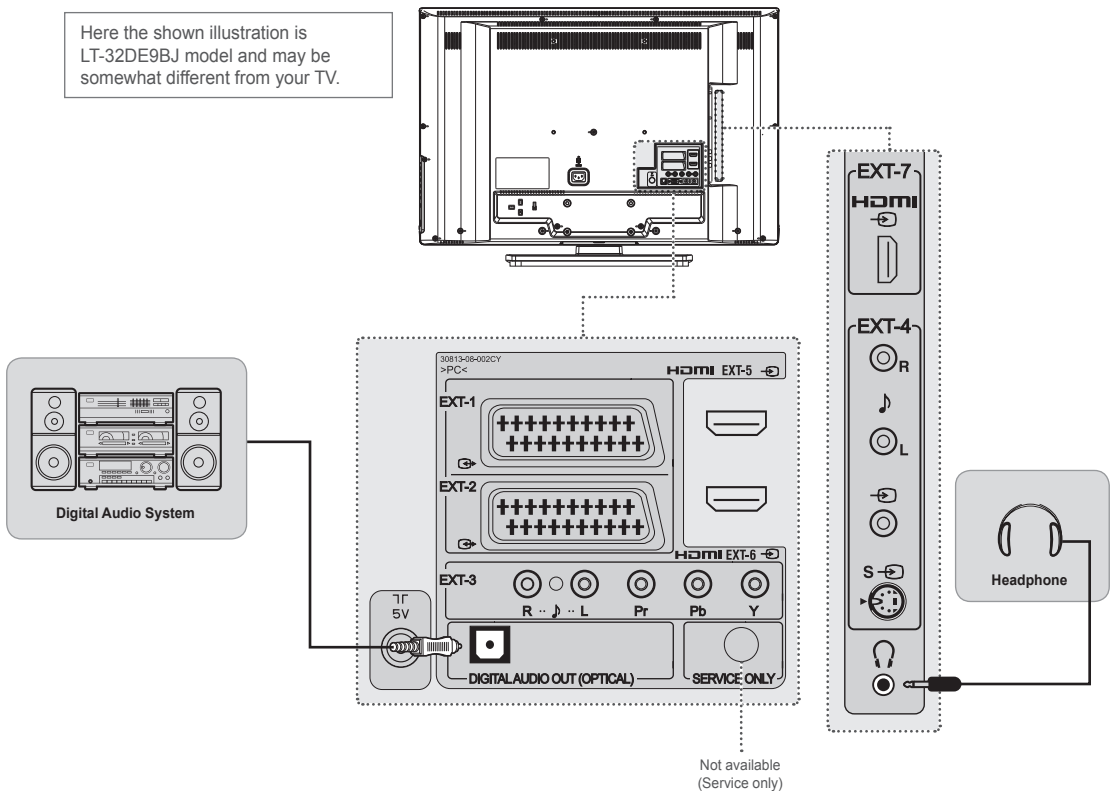

Connecting Headphones

Connect a set of headphones to **HP** on TV if you want to watch a television programme without disturbing other people close to you.

NOTE: Prolonged use of headphones at a high volume may cause health damage on your ears.

INSTALLATION WIZARD

Wizard for Digital Channels (In Digital TV Mode Only)

The installation wizard for digital channels will appear automatically when you perform the followings;

- Turning on your TV for the first time after purchase. (Refer to p.18)
- Performing the default setting in **DTV Setup > Installation** menu when Digital TV mode. (Refer to p.30)

NOTE:

- This wizard is available in Digital TV mode only.
- The options given of the installation wizard may vary according to area.
- If you exit the installation wizard without fully completing the channel searching procedure, you may not have all of the channels available. In this case, you can use the **DTV Setup > Installation** menu to search for more channels.



1 Language: Select the main language.

2 Area Setting: Select the country.

3 Channel Search

Please wait for finishing the channel search. If you want to stop during search, press the **OK** button. If the channel search is stopped or finished, you can edit the found channels.

- **Select All:** Select all the found channels.
- **Unselect All:** Unselect all the found channels.
- **Delete:** Delete the selected channels.

Select **Save** and press the **OK** button to save the result.

4 Time Setting: Set the GMT offset for current time.

NOTE: The current time is set automatically whenever GMT offset changes.

5 Result: After all settings are completed, you can view the result screen. Select **Finish** and press the **OK** button to complete the installation wizard.

Wizard for Analog Channels (APS) (In Analog TV Mode Only)

Firstly, switch to **Analog TV** input mode using the **AV** or **TV/DTV** button.

When you perform the default setting in **Feature** menu, the installation wizard for analog channels will appear automatically. (Refer to p.28)

NOTE: The default PIN code is 0000. If you have forgotten the PIN code, please contact your local TV distributor.

- 1** Shows the main language and country.
- 2** Select **Channel Search** and press the **OK** button.
Please wait for finishing the channel search. If you want to stop during search, press the **BACK** button.
If the channel search is stopped or finished, you can edit the found channels.
 - **Skip:** Sets the channel to be skipped using the **RED** button.
 - **Move:** Shifts the channel using the **GREEN** button.
 - **Delete:** Deletes the channel using the **YELLOW** button.

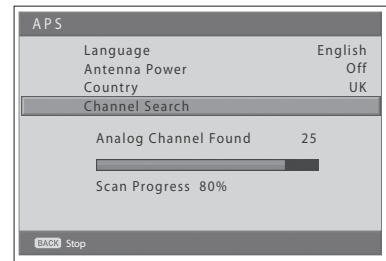

NOTE:

- If you do not want to setup the channels at this time, you can setup it later using the **Installation** menu.
- If you connect an active antenna to the TV, you have to set the **Antenna Power** to **On** to supply the 5V power into antenna. The default value is **Off**. Active antenna is a portable or indoor antenna which needs power supply from the product because it does not have power cord for itself.

BASIC OPERATION

Turning on the TV

- 1 Firstly, connect the power cord correctly. At this stage, the TV switches to standby mode.
- 2 In standby mode to turn TV on, press the **POWER**, **TV/AV** or **P/AV** button on the TV or press the **POWER**, **AV**, **TV/DTV**, **P/AV** or **NUMBER** button on the remote control and the TV will switch on.

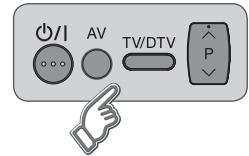

Changing Channel

- 1 Press the **P/AV** button or enter the channel number using the **NUMBER** buttons to move to the channel directly.
- 2 Press the **TV/RADIO** button to switch between digital TV channels and radio channels.
- 3 Press the **TV/DTV** button to switch between analog TV channels and digital TV channels.
- 4 Press the **BACK** button to return to the previous channel.

NOTE: You can switch channels using the channel list or programme guide.

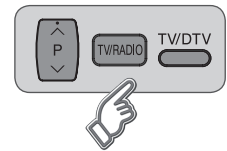

Volume Control

- 1 Press the **VOL+/-** button to adjust the audio volume.
- 2 Press the **MUTE** button to stop the audio temporarily.

NOTE: The mute function remains set while you switch channels.

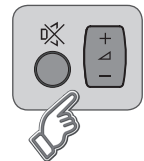

Displaying Information

Programme Information (i-plate) (In Digital TV Mode Only)



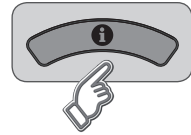



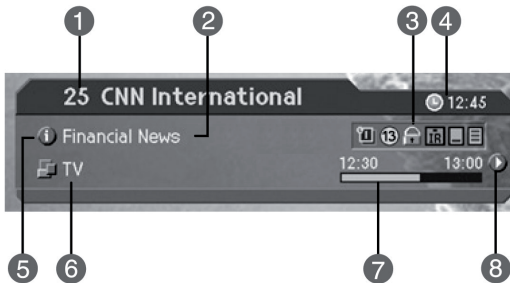





Programme information is displayed for a certain period of time whenever you switch channels. You can view the programme information by pressing the **i** button while watching a programme.



The information is displayed as follows on the screen.



- 1 Channel number and channel name
- 2 Programme name
- 3 Icons

	Reserved programme		Subtitle information
	Locked channel		Teletext information
	Scrambled channel		Parental control level (minimum age for viewing)
	Compressed bitstream audio signal		Teletext information (MHEG)
	Programme on recording		Data channel
	Split programme		Series programme

- 4 Current time
- 5 Detailed programme information: Press the **i** button again to view detailed information.
- 6 Current channel list
- 7 Programme broadcasting time and progress bar
- 8 Next programme information: Press the **▶** button to display the next programme information.

Simple Information (except for Digital TV Mode)

You can view the information such as the channel number (or input source), and sound mode (or source resolution) by pressing the **i** button while watching an analog TV channel or external input source.

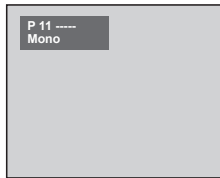

▲ Analog TV Input

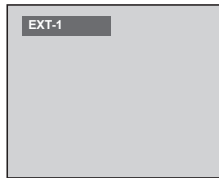

▲ External Input
(SCART, Composite, S-Video)

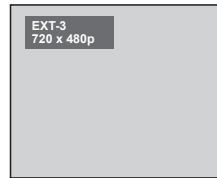

▲ External Input
(Component, HDMI)

Press the **i** button again to view the current time at the top right hand corner of the screen.

NOTE: Whenever you switch channels, this information is displayed for a certain period of time.

Displaying Channel List

Press the **LIST** button while watching a programme to display the channel list.

To change the channel, select a channel using the **▲/▼** button and press the **OK** button.

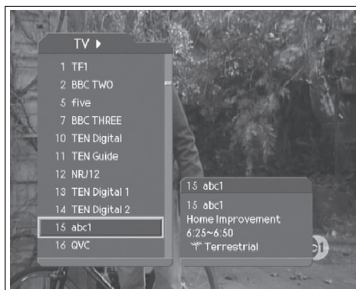

▲ Digital Channel List
(In Digital TV Mode Only)

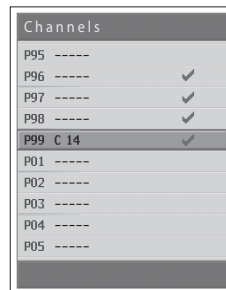

▲ Analog Channel List
(In Analog TV Mode Only)

For Digital Channel List

- Digital Channel List is provided in three types as follows for easy and quick channel browsing; **TV**, **Radio** or **Favourite** channel list. And also you can select Playlist to display the recorded programme list. (Refer to p.40)
- Press the **▶** button to change a channel list group.
- You can move to the channel you want by entering the channel number directly.
- Press the **P/V** button to move to the previous/next page.
- Press the **TV/RADIO** button to switch between TV and radio channel list.
- To display scramble icon (☐) in the channel list, select **On** in **DTV Setup > Configuration > Miscellaneous Settings > Option in CH List** menu.

Digital Programme Features (In Digital TV Mode Only)

Subtitle

If the programme provides subtitle information you can select the language for the subtitle.

- 1 Press the **SUBTITLE** button to display the subtitle language list.
- 2 Select a subtitle language using the **▲/▼** button and press the **OK** button.

NOTE: You can select the default subtitle language in **DTV Setup > Configuration > Language Setting > Subtitle Language** menu.



Audio

If the current programme is available in multiple audio languages, you can select the language you prefer.

- 1 Press the **DUAL SOUND** button.
- 2 Select an audio language using the **▲/▼** button to change audio immediately.
- 3 Select the audio direction (left, right, stereo) using the **◀/▶** button.

NOTE

- You can select the default audio language in **DTV Setup > Configuration > Language Setting > Audio Language** menu.
- If you select **Compressed** in **DTV Setup > Configuration > Language Setting > Audio Priority** menu, the programme is automatically broadcasted in the compressed audio regardless of default audio language. If the programme is broadcasted in the compressed bitstream audio signal, you cannot set the audio direction.

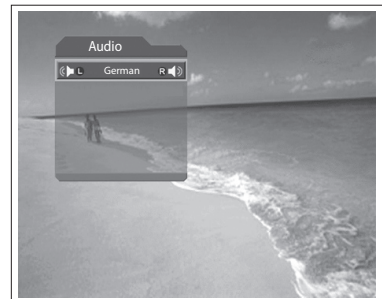

Text and Interactive Services

If your chosen channel has digital teletext features, you can access them. Teletext services often load automatically shortly after the digital teletext window is displayed. In which case, simply follow the on screen instructions (press color buttons).

- 1 Press the **TEXT ON/OFF** button to access digital teletext.
- 2 Press the **TEXT ON/OFF** button again to return to normal viewing.
- 3 Press the **P/VV** button to exit this service.

Note: If you have subtitles displayed then you will not be able to access the digital text service.



Selecting the Main Input Source

Once you have connected your various audio and video systems, you can view different sources by selecting input sources.

- 1 Press the **AV** button.
- 2 Select a main input among the sources and press the **OK** button.

NOTE: You can easily switch to digital TV from different sources by pressing the **TV/DTV** button.



Setting the Aspect Ratio

You can select an aspect ratio mode by pressing the **ZOOM** button repeatedly on the remote control.

Auto - Regular - Panoramic - 14:9 Zoom - 16:9 Zoom - 16:9 Zoom Subtitle - Full

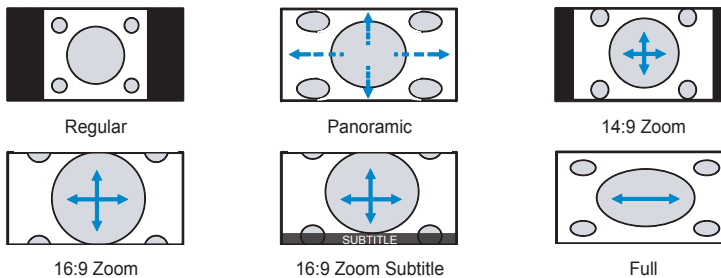
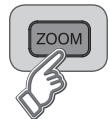

NOTE:

- When **Auto** is selected, you can select a default aspect ratio for 4:3 signal. (except when 480p/576p mode)(Refer to p.28)
- When the component or HDMI input mode with 480p or 576p signal, you can select only the Auto, Full or Regular.
- When the component or HDMI input mode with 720p or 1080i signal, you can select only the **Full**, **HD Zoom** or **Slim**.

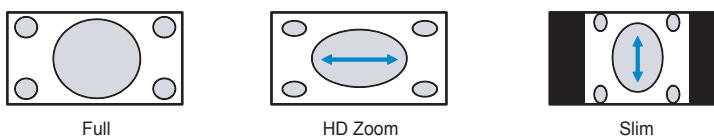

- For pictures with a 16:9 aspect ratio that have been squeezed into a normal picture (4:3 aspect ratio), select **Full** mode to restore their original dimensions.

To move the picture vertically:

If you cannot see subtitles at the bottom of the screen, or if the top or bottom is cut off, move the picture vertically using the **▲/▼** button before the display disappears.

NOTE: If you change the aspect ratio mode, the picture returns to its default position.

Displaying Teletext information







You can display teletext information at any time on your TV.

Most TV broadcasting stations provide text information services via teletext. The index page of the teletext service gives you information on how to use the service.

NOTE: To properly display teletext information, channel reception must be stable. Otherwise, information may be missing or some pages may not be displayed.

You can also select various options to fit your needs using the remote control buttons.

TELETEXT function buttons are as follows:

TEXT ON/OFF	Activates or deactivates the teletext service.
MIX	Overlaps the teletext with the broadcasting screen. Adjusts the opacity to the background in Teletext mode.
 (Index)	Displays the teletext index page.
 (Cancel)	Displays TV programme when waiting for the new teletext page.
 (Reveal)	Shows the hidden information. (answers to quiz games, for example) Press it again to return to normal display.
F.T/L (MODE)	Selects the teletext mode (LIST/FLOF)
 (Size)	Displays the double-size letters for lower half of the screen, press it again to return to normal display.
 (Hold)	Holds the display on a given page if the selected page is linked with several secondary pages that automatically follow. To resume, press it again.
 (Subpage)	Displays the available subpage.
Number (0-9)	Press to enter the three-digit page number given in the content.
▲/▼ & P▲/▼	Moves up or down a teletext page.

Coloured buttons (Red/Green/Yellow/Blue)

If the FASTEXT system is used by a broadcasting company, the different topics covered on a teletext page are colour-coded and can be selected by pressing the coloured buttons. Press one of them corresponding to your needs. The page is displayed with other coloured information that can be selected in the same way. To display the previous or next page, press the corresponding coloured button.



PROGRAMME GUIDE (IN DIGITAL TV MODE ONLY)

The Programme Guide displays the programme information about each digital channel, based on the date and time. You can also schedule your recording using the information given.

Press the **GUIDE** button to display the programme guide.

NOTE: Press the **GUIDE** button again to exit the guide screen.

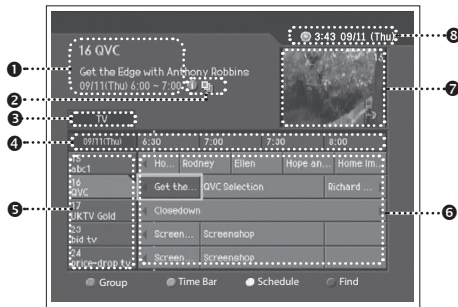

- 1 Current programme information : channel number and name, programme name, broadcasting time
- 2 Icons
 - Split programme
 - Series programme
 - Reserved programme
 - Auto tracking
- 3 Group name
- 4 Time bar
- 5 Channel list
- 6 Programme list
- 7 Preview window
- 8 Current date and time

NOTE:

- **Auto tracking** can track the changes of the reserved programme and keep the reservation. Even when the broadcasting time of the reserved programme is changed, you can still record the reserved programme with the auto tracking feature.
- Auto tracking, split and series reservation are enabled only when **Recording's Start/End Time** in the menu is set to **On Time**. (p.44)

- 1 Move to another channel using the **▲/▼** button and move to previous or next programme within the same channel using the **◀/▶** button.
- 2 Move back 2 hours or move 2 hours ahead within the same channel using the **FAST REWIND (◀◀)** or **FAST FORWARD (▶▶)** button.
- 3 Use the **REPLAY** and **SKIP** buttons to move to move Back or Forward 1 day.
- 4 Select a programme and press the **OK** button. Then you can watch the programme if it is on air or reserve it if it is the future programme.
- 5 Press the **i** button in the selected programme to view the detailed information (if available) of the selected programme.

NOTE: Press the **P/V** button to move to the previous/next page.

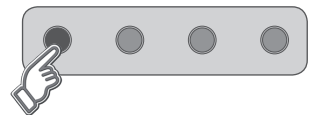

Changing the Channel List Group

You can view programme information of the selected channel list by groups.

- 1 Press the **RED** button to display the channel list group.
- 2 Select a channel list group and press the **OK** button.







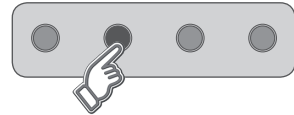

Moving the Time Bar

You can quickly search the time zone using the time bar.

- 1 Press the **GREEN** button to display time control bar.
- 2 Select each button and press the **OK** button to move the time bar. If you press a button repeatedly, the same operation is repeated.



-  Exits the time control bar.
- Now** Moves to the current programme.
-  Moves back to the previous programme or 30 minutes before.
-  Moves forwards to the next programme or 30 minutes ahead.
-  Moves back to 2 hours before.
-  Moves forwards to 2 hours ahead.
-  **Day** Moves back to one day before.
- Day**  Moves forwards to one day ahead.

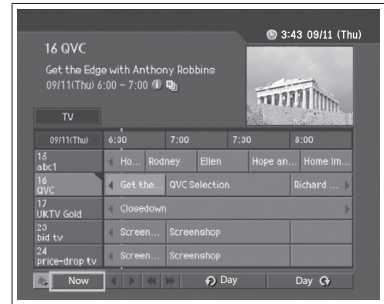

- 3 You can also use the **FAST REWIND** (◀◀) / **FAST FORWARD** (▶▶) and **REPLAY/ SKIP** buttons on the remote control.

Reserving a Recording (Schedule)

You can reserve a recording of the future programme in the Programme Guide.

- 1 Select the desired programme and press the **OK** button.
- 2 When a reservation has been completed, the icon (📅) is displayed on the reserved programme. Press the **OK** button again to cancel reservation.
- 3 If you select a split programme, a pop-up will appear. Press the **OK** button.
- 4 If you select a series programme, a pop-up will appear. Select an option you want and press the **OK** button.
- 5 By the reserved time, the programme will be recorded.

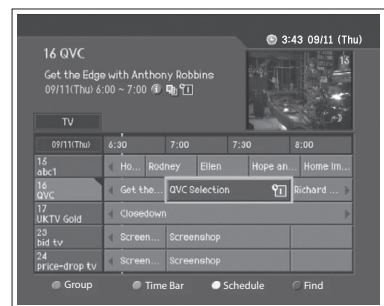

NOTE:

- If the channel is locked or restricted by parental control, you will be prompted to enter your PIN code to complete the reservation. The default PIN code is 0000. If you have forgotten your PIN code, please contact your local TV distributor.
- You can reserve two programmes to record simultaneously.

PROGRAMME GUIDE (IN DIGITAL TV MODE ONLY)

Schedule

Press the **YELLOW** button to display the schedule list. The schedule screen displays the reserved programme list and lets you add, edit or delete the reservations.

NOTE:

- For more information about how to add, edit or delete a reservation, refer to **Recording Schedule** (p.39).
- You can also easily display the schedule screen by simply pressing the **SCHEDULE** button on the remote control.

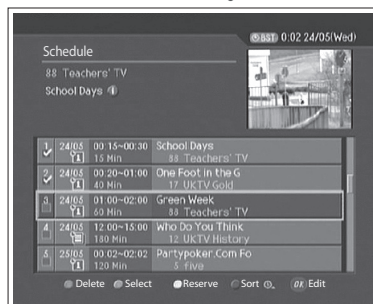
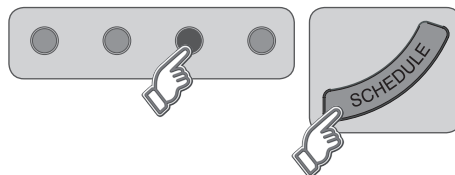

Finding a Programme

You can sufficiently find the programme you want by programme name or genre.

- Press the **BLUE** button to move to the Find screen.
- Enter the programme name directly and select **Find** and press the **OK** button.

NOTE: If you select **Previous** or **Next** on the keyboard displayed on the screen and press the **OK** button, the keyboard layout is switched.

- Select **By Genre** and press the **OK** button to search programme by genre.
- Select the genre and press the **OK** button.

- If you select a programme from **Found Programme List** screen and press the **OK** button, you can watch the programme if it is on air or reserve it if it is the future programme. If you want to find another programmes, press the **BACK** button to return to the previous menu.

NOTE: **Found Programme List** may differ depending on the provided programme information.

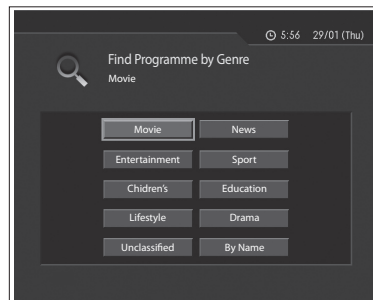
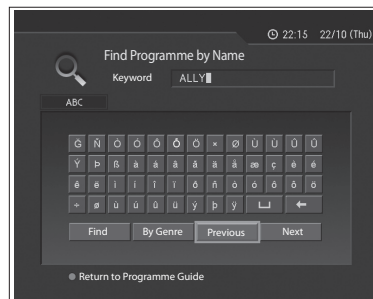
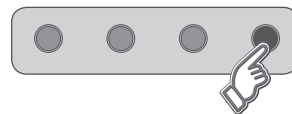

MENU SETTINGS

You can customize your TV which best fits your requirements using the various TV menus.

How to Navigate the Menu

Button	Action
MENU	Displays the menu.
▲/▼	Moves among menus or items.
OK or ►	Selects (Enters) a menu or confirms a selection.
◀/►	Adjusts or configures the option.
BACK	Goes back to the previous screen.
NUMBER	Enters the number (0~9).

NOTE: The default PIN code is 0000. If you have forgotten the PIN code, please contact your local TV distributor.

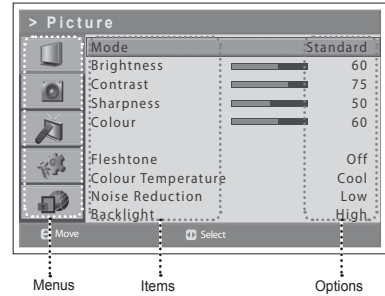

Picture Settings : ^{MENU} ● > Picture

- **Mode:** Bright - Game - Soft - Manual - Standard
When selecting Manual, you can adjust the values of the Brightness/ Contrast /Sharpness/Colour/Hue items.
- **Fleshtone:** Off - Low - Medium - High
Use to improve the picture quality by adjusting colour balance.
- **Colour Temperature:** Cool - Normal - Warm
- **Noise Reduction:** Low - Medium - High - Off
- **Backlight Brightness:** High - Low - Medium

NOTE: You can adjust the Hue item only in NTSC signal.

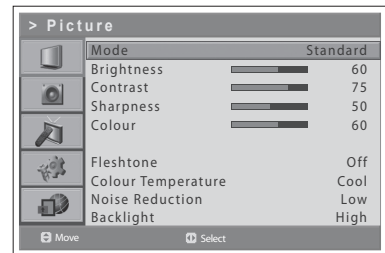

Sound Settings : ^{MENU} ● > Sound

- **Bass:** Adjusts the strength of low tones
- **Treble:** Adjust the strength of high tones
- **Balance:** Adjusts the balance of speaker.
- **AVL(Auto Volume Level):** Off - On
Adjusts automatically the volume of the channel depending on the signal modulation.
- **Hyper Sound:** Off - On
Gives the ambient sound effect.

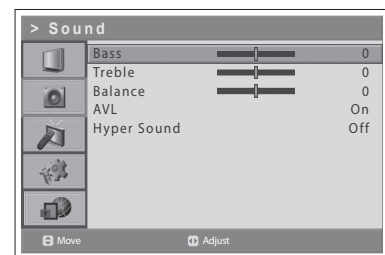

Installation Settings (In Analog TV Mode Only) : MENU > Installation

- **Country:** Shows the country.
- **Antenna Power:** Off - On
If you connect an active antenna to the TV, you have to set the **Antenna Power** to **On** to supply the 5V power into antenna. The default value is **Off**. Active antenna is a portable or indoor antenna which needs power supply from the product because it does not have power cord for itself.
- **Auto Search:** (Refer to p.31)
- **Manual Search:** (Refer to p.32)
- **Edit Channels:** (Refer to p.32)

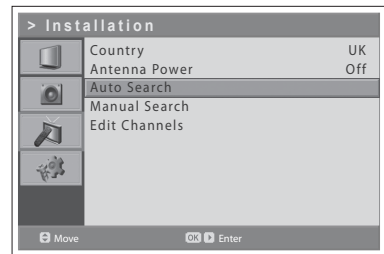

Feature Settings : MENU > Feature

- **Language:** Shows the main language.
- **Time Setting:** (Refer to p.29)
- **Parental Control:** (Refer to p.29)
- **OSD Transparency:** 30 - 50 - 70 - 100 - Disable
- **Blue Back:** Off - On
When watching a channel with no or poor reception, or if there is no input from an external device, you can change the screen into a blue.
- **Power Lamp:** On - Off
Illuminates the power lamp in blue on the front panel.
- **4:3 Aspect Setting:** Panoramic - Regular (Refer to p.22)
Select a default aspect ratio for 4:3 signal when the aspect ratio is set to **Auto**. (except when 480p/576p mode)
- **Default Setting:** (Enabled only in Analog TV mode.)
Sets the current all settings of the TV to the default settings except for the Digital TV mode settings.

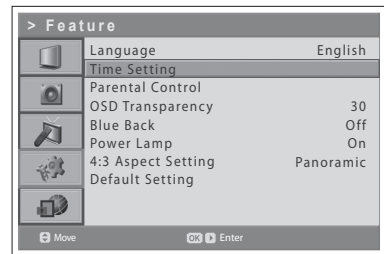

NOTE:

- Please note that once you perform the Default Setting, all data such as analog channel list, and user configured data are deleted.
- After completing the default setting, the installation wizard (APS) for analog channels will appear automatically in a few seconds.
- For more information about Default Setting of the digital channels, refer to p.30.

Time Setting

Select **Feature > Time Setting**.

- **Date**: Shows the current date.
- **Local Time**: Shows the current time.
- **Power On Time**: Select On to set time for turning on the power and then enter hour/minute. At the preset time, the TV will automatically be tuned on.
- **Power Off Time**: Select On to set time for turning off the power and then enter hour/minute. At the preset time, the TV will automatically be tuned off.
- **Auto Power Off**: Select On to turn TV off automatically for reduction of power consumption when there is no signal.

NOTE: Your TV automatically sets and updates the date and time over the air when you successfully search digital channels. Otherwise you can set the date and time manually using the **NUMBER** button.

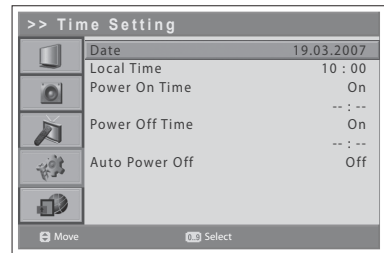

Parental Control

Select **Feature > Parental Control**.

Enter your PIN code.

NOTE: The default PIN code is 0000. If you have forgotten your PIN code, please contact your local TV distributor.

- **Child Lock**: Select **Enable** to lock the buttons on the front panel.
NOTE: To unlock, press the **TV/AV** and **▼** buttons on the front panel of the TV together for 3 seconds.
- **Change PIN CODE**: Change the current PIN code to a new one.

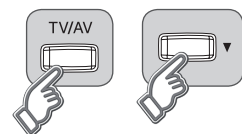

DTV Setup (In Digital TV Mode Only) : ^{MENU} ● > DTV Setup

- **Record** : (Refer to p.35)
- **Configuration**: (Refer to p.45)
- **Edit Channels**: (Refer to p.34)
- **Installation**:
 - **Auto Search / Manual Search**: (Refer to p.33)
 - **Software Update**: (Refer to p.47)
 - **Default Setting**: (for Digital TV Mode Only)

Sets the current all settings of the Digital TV mode to the default settings.

NOTE:

- Please note that once you perform the Default Setting, all data such as digital channel list, and user configured data are deleted. But, no information on your HDD will be removed.
- After completing the default setting, the installation wizard for digital channels will appear automatically in a few seconds.
- For more information about Default Setting of the analog channels, refer to p.28.

- **System**

- **Status**: You can view system information.
- **Signal Detection**: You can view the signal strength and signal quality of the channel that is currently on air.
- **Common Interface**: You can view the current status of the CAM (Conditional Access Module).

NOTE: The displayed information about a Common Interface may differ depending on Common Interface type

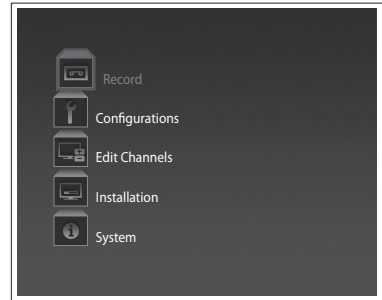
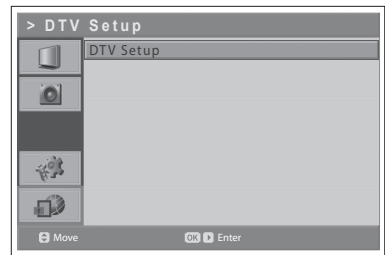

ANALOG CHANNEL SETTINGS (IN ANALOG TV MODE ONLY)

Analog channels can be searched and edited only in Analog TV input mode.

NOTE: You can access this menu only in Analog TV input mode.

How to Navigate the Menu

Button	Action
MENU	Displays the menu.
▲/▼	Moves among menus or items.
OK or ►	Selects (Enters) a menu or confirms a selection.
◀/▶	Adjusts or configures the option.
BACK	Goes back to the previous screen.
NUMBER	Enters the number (0~9).

1 Switch to **Analog TV** input mode using the **AV** or **TV/DTV** button.

2 Select **Installation** menu.

- **Country:** Shows the country.
- **Antenna Power:** Off - On.

If you connect an active antenna to the TV, you have to set the **Antenna Power** to **On** to supply the 5V power into antenna. The default value is **Off**. Active antenna is a portable or indoor antenna which needs power supply from the product because it does not have power cord for itself.

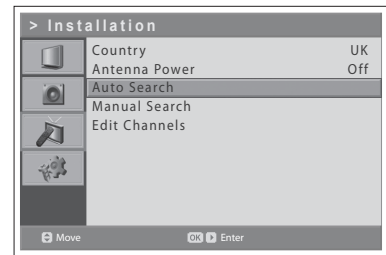
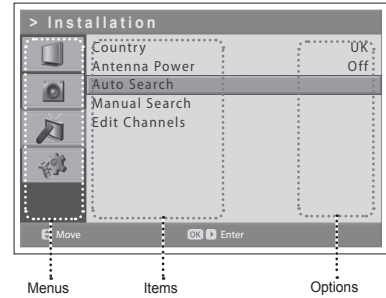

Automatic Search

Select **Auto Search > Search** to start to search channels.

The found channels are automatically saved in order.

To stop searching channels, press the **BACK** button.

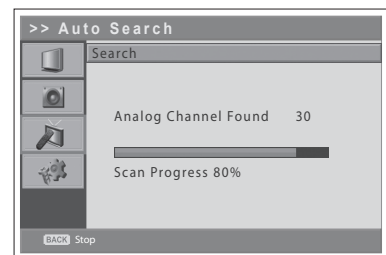

Manual Search

Select **Manual Search**.

- **Colour System:** Auto - PAL - SECAM
- **Audio System:** BG – I – DK - L
- **Band:** C (Air Channel) - S (Cable Channel)
- **Channel:** Choose or enter the channel number.
- **Programme No:** Choose or enter the programme number.
- **Name:** Enter the new channel name.
- **Search:** Starts to search channels.
- **Fine Tune:** Use to obtain a good quality of the picture and sound.
- **Save:** Saves the found channel as current setting.

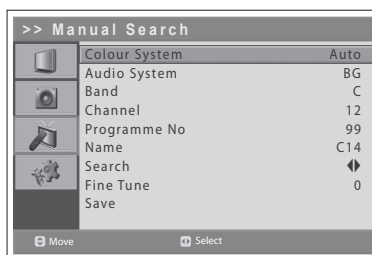

After the channel searching completes, the **Edit Channels** menu is displayed automatically. The first found channel, if only, will be automatically displayed.

Edit Channels

Select **Edit Channels**.

- **Skip:** Sets the channel to be skipped using the **RED** button.
Once channels are selected to skip, you can select the skipped channels using number buttons only.
- **Move:** Shifts the channel using the **GREEN** button.
- **Delete:** Deletes the channel using the **YELLOW** button.

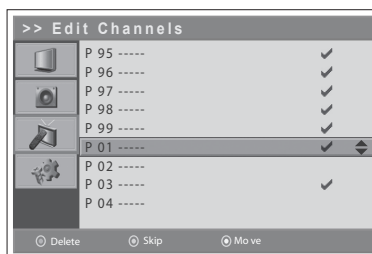
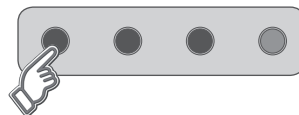

DIGITAL CHANNEL SETTINGS (IN DIGITAL TV MODE ONLY)

Digital channels can be searched and edited only in Digital TV input mode.

NOTE: You can access this menu only in Digital TV input mode.

How to Navigate the Menu

Button	Action
MENU	Displays the menu.
▲/▼	Moves among menus or items.
OK or ►	Selects (Enters) a menu or confirms a selection.
BACK or ◀	Goes back to the previous screen.
NUMBER	Enters the number (0~9).

NOTE:

- The default PIN code is 0000. If you have forgotten the PIN code, please contact your local TV distributor.
- You can easily navigate the DTV Setup menus using the assigned numeric for each menu. Press the **2-2** buttons in order at **DTV Setup** menu to select **Language Setting** menu.

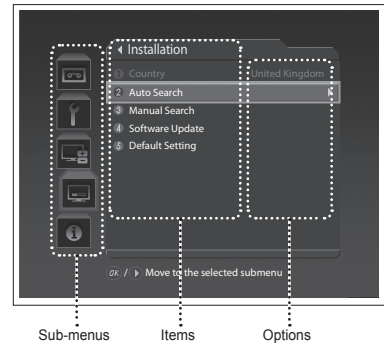

Switch to **Digital TV** input mode using the **AV** or **TV/DTV** button.

Select **DTV Setup > Installation** menu.

- Country:** Shows the selected country in wizard.

NOTE: It is not possible to access the **DTV Setup > Installation** menu during recording or playback. You will need to stop the recording/playback to access the menu.

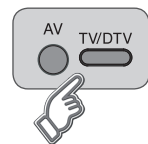

Auto Search

Select **Auto Search**.

It starts to search channels immediately.

Please wait for finishing the channel search. If you want to stop during search, press the **OK** button.

If the channel search is stopped or finished, you can edit the found channels.

- Select All:** Select all the found channels.
- Unselect All:** Unselect all the found channels.
- Delete:** Delete the selected channels.

Select **Save** and press the **OK** button to save.

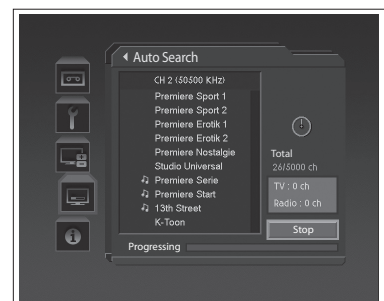
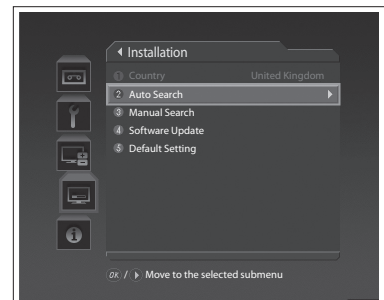

Manual Search

Select **Manual Search**.

- **Channel:** Select a channel to search.
- **Frequency:** Enter the frequency.
- **Network Search:** Enable - Disable

Select **Search** to start searching channels.

Please wait until the channel search is complete.

Manual search is similar to that of the Auto search. Please refer to **Auto Search**.

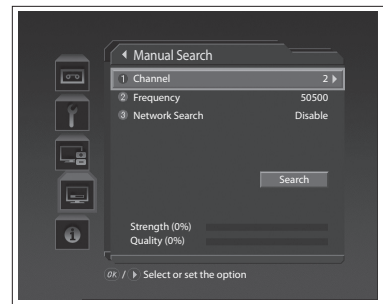

Edit Channels

Select **DTV Setup > Edit Channels** menu.

Edit Channel Lists

Select **Edit Channel Lists**.

- **Group:** Select the group of channel list.
- **Lock:** Lock or unlock the channel.
- **Select All:** Select all channels.
- **Unselect All:** Unselect all the selected channels.
- **Delete:** Delete the selected channels.

NOTE: It is not possible to access the **DTV Setup > Edit Channels > Edit Channel Lists** menu during recording. You will need to stop the recording to access the menu.

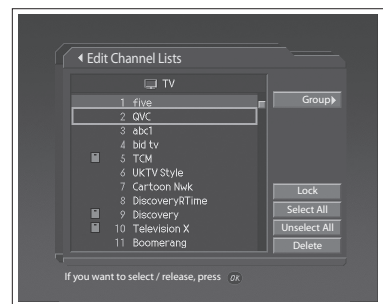
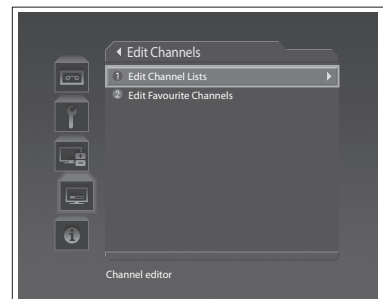

Edit Favourite Channels

Select **Edit Favourite Channels**.

Select a favourite group to edit.

	Add	Adds to the favourite group.
	Remove	Removes from the favourite group.
	TV/Radio	Switches between TV and Radio channel list.
	Fav. Group	Changes the favourite group.
	Move	Changes the order of channels within the favourite group.
	Rename	Renames the name of favourite group.
	Sort	Sorts channels by number or name in all TV/Radio channel list.
	Unselect All	Unselects all selected channels.

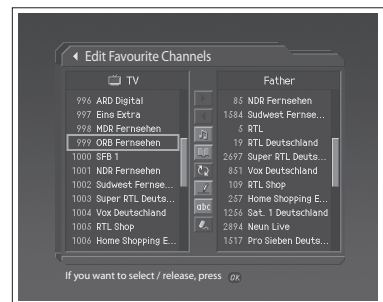

RECORDING AND PLAYBACK (IN DIGITAL TV MODE ONLY)

This chapter describes the PVR (Personal Video Recorder) function that allows you to record a programme in the connected hard disk drive. Using the built-in hard disk drive, you can record a programme without an external media device such as a VCR.

NOTE:

- You can access this menu only in Digital TV input mode. You can record the digital TV or radio programmes only. The analog channels and external AV inputs can't be recorded.
- Do not disconnect the power plug when you reserve the scheduled recordings or while recording a programme. If you disconnect the power plug while recording, the recording will be failed.
- The minimum recording time storable is more than 30 seconds.
- It is not possible to access the **DTV Setup > Installation** menu during recording or playback. You will need to stop the recording/playback to access the menu. And you are not able to edit digital channels during recording.

How to Navigate the Menu

Button	Action
MENU	Displays the menu.
▲/▼	Moves among menus or items.
OK or ►	Selects (Enters) a menu or confirms a selection.
BACK or ◀	Goes back to the previous screen.
NUMBER	Enters the number (0~9).

NOTE:

- The default PIN code is 0000. If you have forgotten the PIN code, please contact your local TV distributor.
- You can easily navigate the DTV Setup menus using the assigned numeric for each menu. Press the **2-2** buttons in order at **DTV Setup** menu to select **Language Setting** menu.

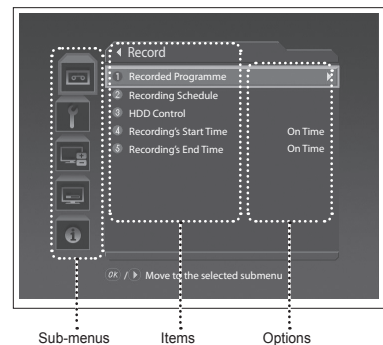

Time Shifted Recording (TSR)

The TV automatically record the programme on air in the installed hard disk drive temporarily, so that users can pause, play, fast rewind, fast forward, instant replay, etc. even while watching the currently broadcasting TV programme.

NOTE: For more information on the playback control, refer to **Playback Control Buttons** (p.36).

TSR Play Bar

If you press the playback control buttons while watching TV, the TSR Play bar appears on the bottom of the screen. TSR Play bar displays the current operation status, the time gap between the broadcasting point and watching point, and the amount of temporarily saved programme.

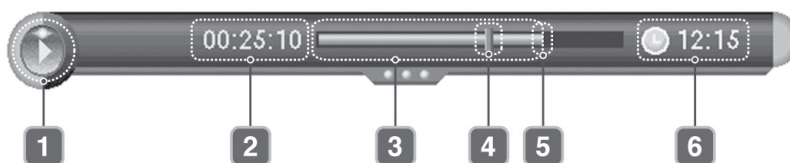

- 1 Operation status
- 2 Watching point time (hh:mm:ss)
- 3 The amount of saved programme
- 4 Watching point
- 5 Broadcasting (Live) point
- 6 Current time (hh:mm)

NOTE: When the operation status is PLAYING or LIVE on the TSR Play bar, if you take no action for about 10 seconds, the TSR Play bar will disappear.

Playback Control Buttons

Pause

If you press the **PAUSE (||)** button on the remote control, the current programme is paused. If you press the **PAUSE (||)** button once again, the programme is resumed from that point..

NOTE: Pause makes the time gap or delay between the broadcasting (live) point and watching point. The time gap is equivalent to the period the programme was paused. Operations like slow motion and fast rewind also make the time gap. Press the **STOP (■)** button to go to the live programme.

Stop

Press the **STOP (■)** button to stop the playback and go to the live programme.

Fast Forward to the Next Scene

Press the **FAST FORWARD (►►)** button on the remote control to fast forward the programme. Each time you press the **FAST FORWARD (►►)** button, the speed increases. (x2, x4, x16, x32, x64)

If you press the **PLAY (►)** button, the fast forward operation stops and the programme is played at normal speed.

NOTE: You can use the fast forward operation only when there is a time gap between the current watching point and the broadcasting (live) point caused by some previous operations such as pause, slow motion or fast rewind. You can fast forward to the current broadcasting point. If the watching point reaches the broadcasting (live) point, the programme is automatically played at normal speed.

Fast Rewind to the Previous Scene

Press the **FAST REWIND (◀◀)** button on the remote control to watch the scene passed by. Each time you press the **FAST REWIND (◀◀)** button, the rewind speed increases. (x2, x4, x16, x32, x64)

If you press the **PLAY (►)** button, the fast rewind operation stops and the programme is played at normal speed.

NOTE: You can fast rewind back to the start point. If you reach the start point while rewinding, the programme is automatically played at normal speed from that point.

Slow Motion

Press the **SLOW** button to play the current programme in slow motion. Each time you press the **SLOW** button, the speed decreases (x 1/2 , x 1/4, x 1/8). Press the **PLAY (►)** button to stop playing in slow motion and return to normal speed.

Instant Replay

Press the **REPLAY** button to replay the current programme from the 7 seconds before. When the replay has been completed, the programme will play from the current point.

To change the instant replay time, refer to **Miscellaneous Settings** (p.46).

Commercial Skip

Press the **SKIP** button to skip 30 seconds ahead from the current watching point. You can use the skip operation only when there is a time gap between the current watching point and the broadcasting point. If the time gap is less than 30 seconds, the programme is played from the current broadcasting point. To change the commercial skip time, refer to **Miscellaneous Settings** (p.46).

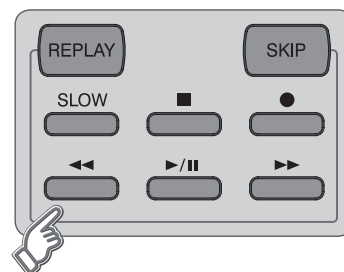

RECORDING AND PLAYBACK (IN DIGITAL TV MODE ONLY)

Direct Jump

If you press the ◀/▶ button during playing, a white moving indicator will appear in the progress bar. Move this indicator to a desired time point using the ◀/▶ button and then press the **OK** button to play the programme from the specified time point. You can also move to the specified time point directly by entering the time (hh:mm) you want using the **NUMBER** button while playing back a recorded programme.



Repeat Mode

You can select a specific block within a recorded programme and play it back repeatedly. Press the **A-B** button to set the first repeating position. Select the second position using the ◀/▶ button and press the **OK** button. Then the programme plays back the selected block repeatedly. To stop the repeat mode, press the **A-B** button while repeating the selected block. Press the **STOP** button to stop playing the saved programme and watch the current programme on air.

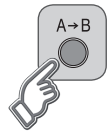

NOTE: The repeat mode is only available for recorded programmes.

Bookmark

You can jump to a position directly using the bookmark in recorded programme playback. Use bookmarks to search positions quickly and easily.

NOTE: The bookmark function is only available for recorded programmes.

- **Adding a bookmark:** Press the **BOOKMARK ADD** button at a certain position to set a bookmark while playing back a recorded programme.
- **Deleting a bookmark:** Press the **BOOKMARK JUMP** button after adding a bookmark and select the bookmarked position using the ▲/▼ button. Press the **BOOKMARK ADD** button to delete a bookmark.

NOTE: Press the **BOOKMARK JUMP** button to exit the bookmark list screen.

- **Going to a bookmark:** Press the **BOOKMARK JUMP** button. Select the bookmarked position using the ▲/▼ button and press the **OK** button. Then the programme plays from the bookmarked position.

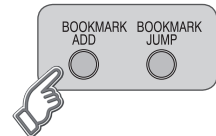

NOTE: A-B Repeat (A→B), **BOOKMARK ADD** and **BOOKMARK JUMP** buttons do not work on TSR Play bar.

Instant Recording

Press the **RECORD** (●) button to record the current programme instantly. You can record up to two channels simultaneously. While recording two channels simultaneously, you can perform TSR(Time Shifted Recording) and view the programmes on air.

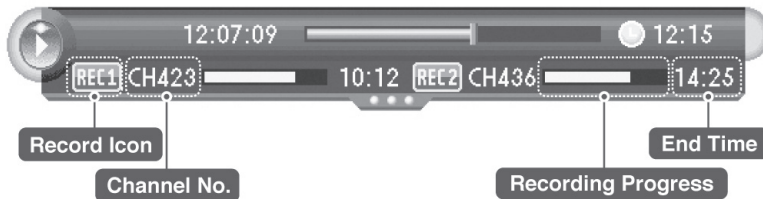
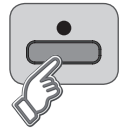

Press the **STOP** (■) button to stop the recording. If you stop while recording two other channels, you will be prompted to select one among the recording channels.



If a reserved recording is about to start while recording two other channels already, you will be prompted to stop one of the currently recording channels.

NOTE:

- Ensure that there is enough free space before recording. If the free space on the hard disk drive is insufficient, recording will stop. Recording one hour of programme may require up to 2 or 3GB of hard disk space. The space for recording a 1 hour programme may differ depending on the programme.
- You can record radio programmes also.

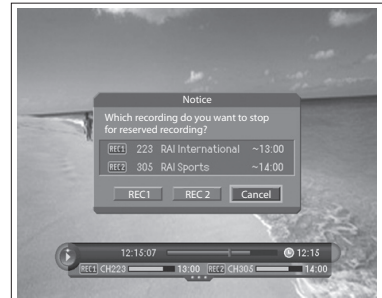

Adjusting the Recording End Time

Press the **RECORD** (●) button while recording to adjust the recording end time. You can adjust the recording end time by +/-10 minutes using the ◀/▶ button, and then press the **OK** button to change the recording end time and hide the message screen.

Descrambling and Re-recording

You can descramble and re-record the recorded file.

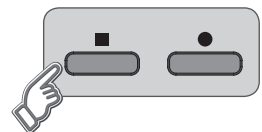

- 1 Press the **RECORD** (●) button at the point you want to record while playback.
- 2 Press the **STOP** (■) button to stop recording. A pop-up message will appear. Select **Yes** and press the **OK** button. Then the recording will stop but the playback will continue.
- 3 To find new recorded files in the play list, press the **PLAYLIST** button.

Recording Schedule

You can set a programme to record automatically.

Select **DTV Setup > Record > Recording Schedule** menu.

- **Select:** Select/Unselect the reserved programme using the **GREEN** button. You can select multiple programmes.
- **Delete:** Delete the selected programme using the **RED** button.
- **Reserve:** Add a new reservation using the **YELLOW** button.
- **Sort:** Sort the list by descending time, ascending time or name using the **BLUE** button.
- **Edit:** Edit the reservation information using the **OK** button.

NOTE:

- You can schedule recording easily using the programme guide. Refer to **Reserving a Recording > Schedule** (p.26).
- You can delete multi programmes except for the protected programmes.

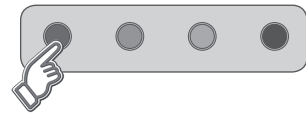
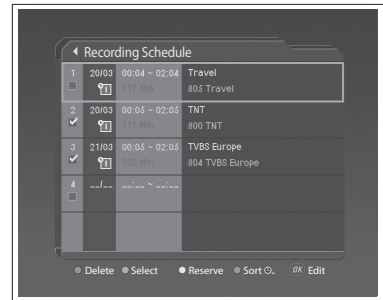

Adding/Editing a Reservation

- 1 Press the **YELLOW** or **OK** button.
- 2 Change **Channel** and **Date** using the **▶** button.
- 3 Change **Start/End Time** using the **NUMBER** buttons.
- 4 Change **Repeat** mode: Once () - Daily () - Weekly () - Weekday () - Weekend ().
- 5 Change **Lock** mode: Disable – Enable.
- 6 Select **Save** and press the **OK** button to complete.
- 7 Select **Cancel** and press the **OK** button to cancel.

NOTE:

- The recording schedule can be overlapped with up to two other programmes.
- The Power On/Off time can overlap the recording schedule.
- The recording icon will be displayed when the programme is being recorded.
- Press the **i** button to see the detailed information about the programme you have selected if provided.
- If the lock option of a programme is configured to **Enable**, you have to enter a PIN code to playback the programme.

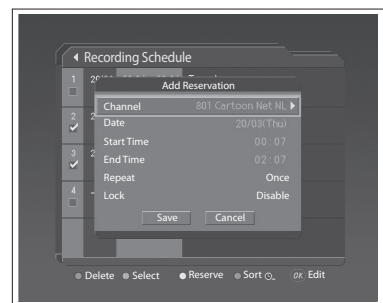

Programme Playback in the Play List



You can easily view the recorded programme list by pressing the **PLAYLIST** button. You can switch among **VIDEO (TV)**, **AUDIO (radio)** and **Selected Files** list using **◀/▶** button.

VIDEO/AUDIO List

- 1 Select **VIDEO/AUDIO** list using the **◀/▶** button.
- 2 Select the programmes and press the **GREEN** button to select the recorded programmes. To unselect the selected programmes, press the **GREEN** button again.
- 3 Select the programmes you want to delete using the **GREEN** button and press the **RED** button to delete the recorded programmes.
- 4 Select the programmes you want to move using the **GREEN** button and press the **YELLOW** button. Move the cursor to the destination using the **▲/▼** button and press the **OK** button. A pop-up will appear. Select **Yes** and press the **OK** button.
- 5 Each time you press the **BLUE** button, the sorting order of the recorded programmes change in the following sequence: by descending time, by ascending time, by name.
- 6 Select programmes you want to playback using the **GREEN** button and press the **OK** or **PLAY (▶/II)** button to play the recorded programmes. The programmes will be played in the selected order.
- 7 If you select programmes using the **GREEN** button, the programmes you select will add to **Selected Files** list automatically.
- 8 You can perform fast rewind, fast forward, slow motion, pause, skip and replay functions while you are playing back a recorded programme from the play list. Refer to **Playback Control Buttons** (p.36).

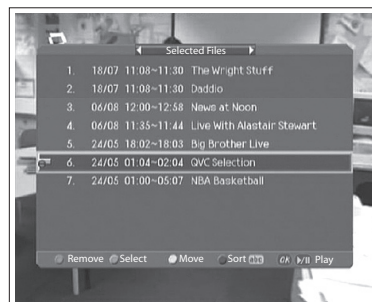
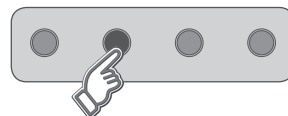
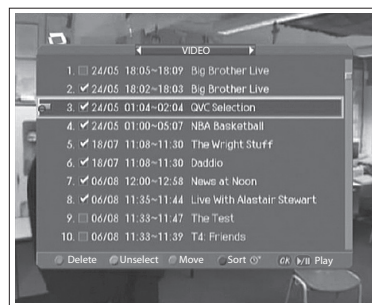

NOTE:

- If you select or playback a split programme, other split programmes are also selected or played back continuously.
- **Move** is inactivated in **VIDEO/AUDIO** list.

Selected Files List

- 1 Select **Selected Files** list using the **◀/▶** button.
- 2 All features are similar to those of **VIDEO/AUDIO** list.

NOTE:

- You also can playback the recorded programme in **DTV Setup > Record > Recorded Programme** menu.
- You can playback the programme currently being recorded.
- The playback icon will be displayed when the programme is being played.
- The recording icon will be displayed when the programme is being recorded.
- Certain parts of the programme may blink when playing back a recorded programme in case the recording mode is switched from scramble to descramble or vice versa.

Play Bar

If you press the playback control buttons while watching the recorded programme, the Play bar appears on the bottom of the screen.

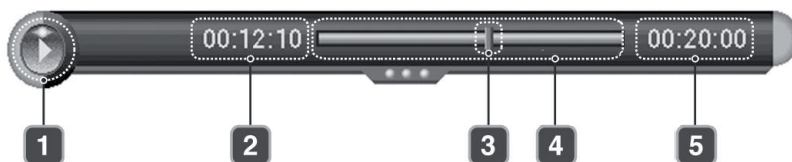

- 1 Operation status
- 2 Elapsed time (hh:mm:ss)
- 3 Watching point
- 4 The amount of saved programme (Total size)
- 5 Total time (hh:mm:ss)

NOTE: When the operation status is PLAYING on the Play bar, if you take no action for about 10 seconds, the Play bar will be disappear.

Chase Play

You can watch the programme from the beginning as the rest of the programme is simultaneously being recorded. While recording two channels simultaneously, you can perform TSR (Time Shifted Recording) using the playback control buttons.

NOTE: You can playback the programme being recorded after it has been recorded for at least 30 seconds.

Editing Recorded Programmes

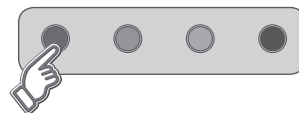

Select **DTV Setup > Record > Recorded Programme** menu.

- **Select:** Select/Unselect the recorded programme using the **GREEN** button. You can select multiple programmes.
- **Delete:** Delete the selected programme using the **RED** button.
- **Edit:** Trim the selected programme or change the attribute of that using the **YELLOW** button.
- **Sort:** Edit the list by descending time, ascending time or name using the **BLUE** button.
- **Play:** Playback the selected programme in the video preview window using the **OK** or **PLAY (▶/⏮)** button. Press the **OK** button again to playback in the full screen.

NOTE:

- The programme being recorded will be added to the recorded programme list after it has been recorded for at least 30 seconds.
- Press the **i** button to see the detailed information about the programme you have selected if provided.
- You can delete multi programmes except for the protected programmes.
- If the protect option of the programme is set to **Enable**, you cannot delete the programme. Please refer to **Changing the Attribute** (p.44).
- When two other reservations with auto tracking conflict, the reservation with the earlier start time starts recording first. If the reservations have the same start time, the one with the lower channel number starts first.

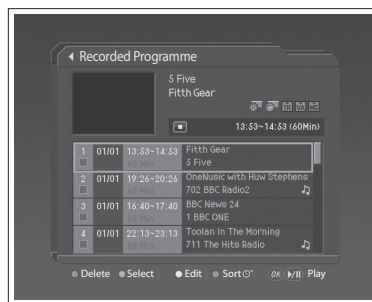

Icons

- Split** Displayed only when the programme is a split programme.
- Series** Displayed only when the programme is a series programme.
- Conflict** Displayed only if the programme was not recorded due to the conflict with other reservations.
- Error** Displayed when the recording is stopped because of an unexpected error.
- Protect** Displayed when the channel is protected from deleting and editing.
- Lock** Displayed when the channel is a locked channel.

Trimming the Recorded Programme

- 1 Select a programme and press the **YELLOW** button. A pop-up will appear.
- 2 Select **Trim** and press the **OK** button.
- 3 You can trim the recorded programme using the following functions.

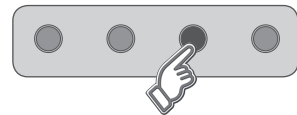

NOTE:

- When selecting multiple programmes, **Trim** is inactivated.
- You can trim recorded TV (Video) channels only.



Save

You can save the selected recording part as a different file.

- 1 Select the starting point using the **◀/▶** button and press the **RECORD (●)** button.
- 2 Select the ending point using the **◀/▶** button and press the **RECORD (●)** button.
- 3 Press the **STOP (■)** button. A pop-up will appear.
- 4 Select **Save** and press the **OK** button to save the selected part.
- 5 Select **Reset** and press the **OK** button to reset the edit.

WARNING: This function will overwrite the original recording.

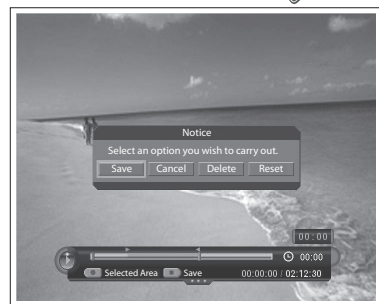
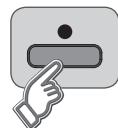

Delete

You can delete the selected recording part.

- 1 Select the starting point using the **◀/▶** button and press the **RECORD (●)** button.
- 2 Select the ending point using the **◀/▶** button and press the **RECORD (●)** button.
- 3 Press the **STOP (■)** button. A pop-up will appear.
- 4 Select **Delete** and press the **OK** button to delete the selected part.
- 5 Select **Reset** and press the **OK** button to reset the edit.

NOTE:

- You can select several parts simultaneously.
- After selecting the point you want using the **◀/▶** button, you can view the scene of the point you select by pressing the **OK** button.

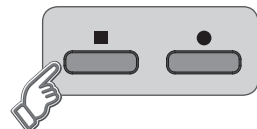

Split

You can split the recorded programme into separate recordings.

- 1 Select the point you want to split using the **◀/▶** button and press the **RECORD (●)** button.
- 2 Press the **STOP (■)** button. A pop-up will appear.
- 3 Select **OK** and press the **OK** button to split the selected point.



RECORDING AND PLAYBACK (IN DIGITAL TV MODE ONLY)

Changing the Attribute

- 1 Select a programme and press the **YELLOW** button to change the attribute of the recorded programme. A pop-up will appear.
- 2 Select **File** and press the **OK** button.
 - **Programme:** Change the programme name using the keyboard.
 - **Protect:** Enable – Disable
 - **Lock:** Enable – Disable
- 3 Select **Save** and press the **OK** button to complete.
- 4 Select **Cancel** and press the **OK** button to cancel.

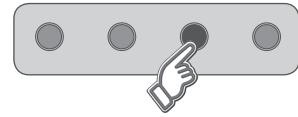

NOTE:

- You have to enter a PIN code to change the status from **Enable** to **Disable**.
- If the protect option of the programme is set to **Enable**, you cannot delete the programme.
- If the lock option of a programme is configured to **Enable**, you have to enter a PIN code to playback the programme.

HDD Control

You can check the free space of the connected hard disk drive and format (erase) the disk drive if necessary.

- 1 Select **DTV Setup > Record > HDD Control**.
- 2 You can check the free, used, reserved and total space of the HDD.
- 3 Select **Format** and to remove all the recorded programmes saved on the HDD and initialize the HDD.
- 4 Select **Yes** when the format confirmation message appears and enter a PIN code to start formatting the HDD.



NOTE:

- The format deletes all the recorded programmes saved in the HDD, not the system files of the TV. A certain amount of space is reserved for TSR.
- The default PIN code is 0000. If you have forgotten the PIN code, please contact your local TV distributor.

Recording's Start/End Time

You can set the start/end time of recording.

Select **DTV Setup > Record > Recording's Start/End Time**.

Select the time using the **▲/▼** button and press the **OK** button.

NOTE: Auto tracking, split and series reservation in the programme guide are enabled only when **Recording's Start/End Time** is set to **On Time**.

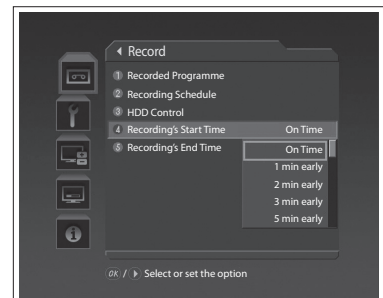

DTV CONFIGURATION (IN DIGITAL TV MODE ONLY)

This chapter describes how to set up the configuration for digital channels.

NOTE: You can access this menu only in Digital TV input mode.

How to Navigate the Menu

Button	Action
MENU	Displays the menu.
▲/▼	Moves among menus or items.
OK or ►	Selects (Enters) a menu or confirms a selection.
BACK or ◀	Goes back to the previous screen.
NUMBER	Enters the number (0~9).

NOTE:

- The default PIN code is 0000. If you have forgotten the PIN code, please contact your local TV distributor.
- You can easily navigate the DTV Setup menus using the assigned numeric for each menu. Press the **2-2** buttons in order at **DTV Setup** menu to select **Language Setting** menu.

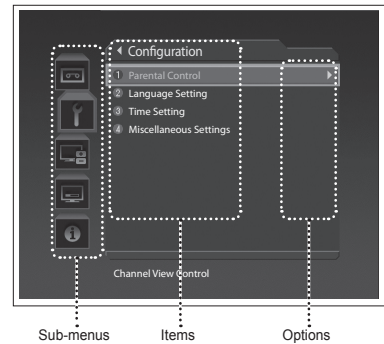

Parental Control

Select **DTV Setup > Configuration > Parental Control**.

- **Maturity Lock:** View All – 4~18
Blocks programmes according to the age level you have set.
- **Change PIN CODE:** Change the current PIN code to a new one.

NOTE:

- You have to enter the PIN code to watch the programme which is blocked by the age level.
- Some broadcasting companies do not broadcast the censorship classification.

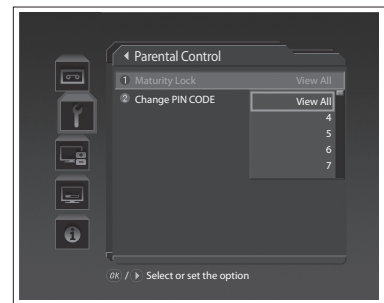

Language Setting

Select **DTV Setup > Configuration > Language Setting**.

- **Audio/Subtitle Language:** Select the language for audio and subtitle.
- **Audio Priority:** Language – Compressed
Select the priority of audio.
Language You can watch programme in the selected language.
Compressed Outputs the compressed audio signal such as Dolby Digital or DTS.

NOTE:

- Select Compressed if your amplifier system has multi-channel digital audio surround decoding (Dolby Digital and/or DTS).
- “Dolby” and the double-D symbol are trademarks of Dolby Laboratories.
- **Subtitle Display:** Auto - Manual
Select to display the subtitle automatically or not.
Auto Displayed in the predefined subtitle language.
Manual Displayed in the language when you select the subtitle language by pressing the **SUBTITLE** button on the remote control.
- **Subtitle Font:** Variable – Fixed
Variable Uses the horizontally variable subtitle font.
Fixed Uses the fixed subtitle font.



Time Setting

Select **DTV Setup > Configuration > Time Setting**.

- **GMT Offset:** Set the GMT offset for current time.

NOTE:

- The current time is set automatically whenever GMT offset changes.
- When **GMT Offset** is set to **Auto**, you have to tune the terrestrial channel for a certain period of time to set the time automatically.



Miscellaneous Settings

Select **DTV Setup > Configuration > Miscellaneous Settings**.

- **i-Plate Display Time:** Set the duration of the information box to be displayed when you switch the channel.

NOTE: When it is set to **Disable**, the i-plate will not be displayed when the channel is switched.

- **OSD Transparency:** Disable – 30 - 50 - 70 - 100
- **Option in Channel List:** Set whether or not to display the scrambled icon in the i-plate and channel list.
- **Instant Replay Time:** 7 - 15 - 30 (sec)
- **Commercial Skip Time:** 15 - 30 - 60 - 120 (sec)

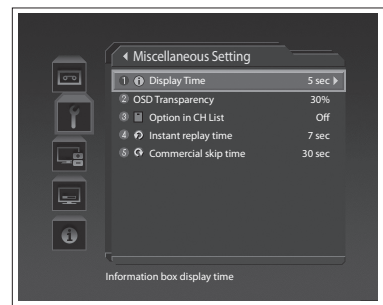

DTV SOFTWARE UPDATE (IN DIGITAL TV MODE ONLY)

In order to maintain proper performance of the TV, it is essential to have the most up-to-date software.

NOTE: You can access this menu only in Digital TV input mode.

How to Navigate the Menu

Button	Action
MENU	Displays the menu.
▲/▼	Moves among menus or items.
OK or ►	Selects (Enters) a menu or confirms a selection.
BACK or ◀	Goes back to the previous screen.
NUMBER	Enters the number (0~9).

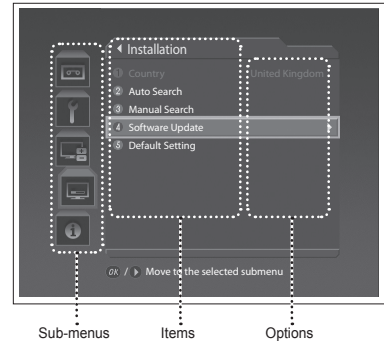

NOTE:

- The default PIN code is 0000. If you have forgotten the PIN code, please contact your local TV distributor.
- You can easily navigate the DTV Setup menus using the assigned numeric for each menu. Press the **2-2** buttons in order at **DTV Setup** menu to select **Language Setting** menu.

Select **DTV Setup > Installation > Software Update**.

NOTE: It is not possible to access the **DTV Setup > Installation** menu during recording or playback. You will need to stop the recording/playback to access the menu.

Automatic Update

- 1 Select **Automatic Update**.
- 2 Automatically search for new software.

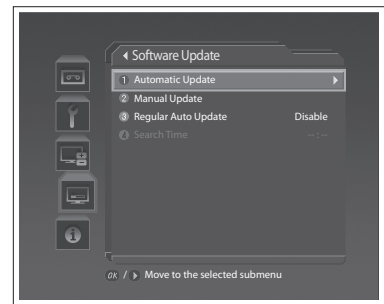

Manual Update

- 1 Select **Manual Update**.
- 2 Select a channel to update and enter the frequency.
- 3 Select **Search** to search software.

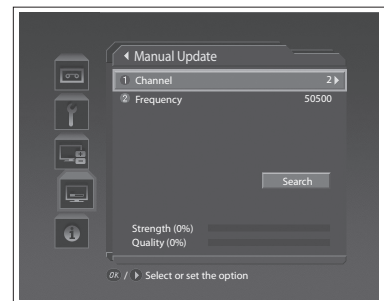

When detecting software update, select **Yes** and press the **OK** button to start updating. Select **No** and press the **OK** button to return to the previous menu without updating. If new software is not found by automatic update, use manual update.

When completing the software update, the TV is automatically powered off and on again.

Regular Auto Update and Search Time

Your TV can start the Regular Auto Update in the standby mode.

- 1 Select **Regular Auto Update** and select **Enable** or **Disable**.
- 2 When you select **Enable**, enter the searching time in **Search Time**.

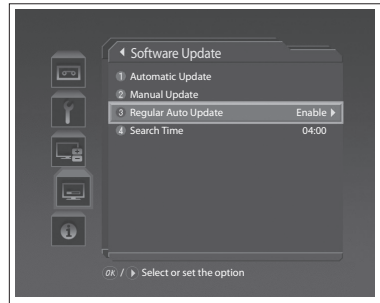

OTA (Over the Air)

OTA, an abbreviation of Over-the-Air, means that the software can be downloaded through your aerial. The manufacturer reserves the right to decide when and where to release software by this process. The software update via your aerial will only occur under the following circumstances.

- 1 The equipment should have appropriate loader software.

Caution: Please note that if you don't have normal loader software, the equipment may not be updated or work after software update.

- 2 The manufacturer decides to release software downloading via a designated aerial system.
- 3 The equipment must be **tuned** properly according to the guidelines within this manual.
- 4 Update software when the quality of receiving signal strength is high. If the weather is not so good that the quality of receiving signal strength is not recommendable, perform the software update later.

Caution:











- Please be careful to keep the power on and the power cord plugged in during software update. If the power is disconnected during software update, it may cause fatal damage to the TV.
- Please be careful not to pull out the signal line (co-axial Cable) during software update. Update may be interrupted and the TV may not work.

NOTE:

- The other functions of TV cannot work at all during software update.
- It may take 5 ~10 minutes to update software.
- Scheduling operation cannot work during software update.

APPENDIX

Menu Map

<p>Picture</p> 	<p>Mode Brightness Contrast Sharpness Colour Hue ----- (NTSC signal only) Fleshtone Colour Temperature Noise Reduction Backlight</p>		<p>p.27</p>
<p>Sound</p> 	<p>Bass Treble Balance AVL Hyper Sound</p>		<p>p.27</p>
<p>Installation (In Analog TV Mode Only)</p> 	<p>Country Antenna Power Auto Search Manual Search Edit Channels</p>		<p>p.28 p.28 p.31 p.32 p.32</p>
<p>Feature</p> 	<p>Language Time Setting Parental Control OSD Transparency Blue Back Power Lamp 4:3 Aspect Setting Default Setting ----- (In Analog TV mode only)</p>		<p>p.28 p.29 p.29 p.28 p.28 p.28 p.28 p.28</p>
<p>DTV Setup (In Digital TV Mode Only)</p> 	<p>Record</p> 	<p>Recorded Programme Recording Schedule HDD Control Recording's Start Time Recording's End Time</p>	<p>p.42 p.39 p.44 p.44 p.44</p>
	<p>Configuration</p> 	<p>Parental Control Language Setting Time Setting Miscellaneous Settings</p>	<p>p.45 p.45 p.46 p.46</p>
	<p>Edit Channels</p> 	<p>Edit Channel Lists Edit Favourite Channels</p>	<p>p.34 p.34</p>
	<p>Installation</p> 	<p>Country Auto Search Manual Search Software Update Default Setting</p>	<p>p.33 p.33 p.34 p.47 p.30</p>
	<p>System</p> 	<p>Status Signal Detection Common Interface</p>	<p>p.30</p>

Troubleshooting

Before contacting your local service dealer, please make sure you refer to the following guide. If the TV does not work normally after completing the following trouble shooting, please contact your local TV distributor or service centre.

(1) No message is displayed or the TV has no power.

- Check the main power cable and make sure it is plugged into a suitable power outlet.
- Check that the mains supply is switched on.
- Connect the power cable to a different power outlet.

(2) No picture

- Make sure that the TV is power on and in operation mode (press the STANDBY button).
- Make sure that the AV cable is firmly connected to the TV. You may need to remove the cable from both ends and reconnect.
- Make sure that the cable is properly connected to the TV.
- Be sure to activate channel search.
- Check the brightness level of the TV.
- Check if the channel is currently on air. Contact the broadcaster to ensure that the channel is running.

(3) Poor picture/sound quality

- Install the antenna in an obstacle-free place.
- Make sure there is no mobile phone or microwave oven near the TV.
- Adjust the antenna direction to get the better picture.
- Set the antenna power in menu to On, if you use the active antenna to improve the reception.
- Check the signal levels and adjust your antenna if the level is too low. The signal level may be affected by weather conditions.

Note: If the antenna is covered with snow or the RF is weakened by heavy rain, the condition of the sound and picture may temporarily be poor. However, the poor sound and picture quality due to weather conditions cannot be accepted as a malfunction of product.

(4) No or poor sound

- Check that your AV cable is connected correctly.
- Check the volume levels of your TV.
- Check if the TV is on mute.
- Check audio type or soundtrack option in the AV menu.

(5) Remote Control does not operate.

- To control the TV, the top end of the remote control should point directly towards the receiving part of the TV.
- Remove and reinsert the batteries in the remote control.
- Replace the batteries in the remote control for a new set.

(6) Cannot make reservations.

- Check that no previous reservations are conflicting with the new reservation.
- Check that the TV is switched on at the time of the reservation.

(7) Cannot watch scrambled channel.

- Check that you have the appropriate Viewing Card. Reinsert the Viewing Card and make sure it initializes correctly.
- Check in the menu that the TV is detecting the Viewing Card.
- Check in the menu that you have a valid and working subscription to the channels you wish to view.
- Ensure that the Viewing Card is not damaged.

(8) No PIN code information is given.

- The default PIN code is always 0000.

(9) Channel search does not work.

- Check that your cable is connected correctly.
- Make sure that the antenna setting in the menu is correct.
- Use the appropriate antenna capable of receiving VHF or UHF channels for your area.

(10) Cannot update new software.

- You can get an update. If the TV does not show a message requesting update, that means no software is available.

(11) Cannot watch pay channels.

- Check in the menu that you have a valid and working subscription to the channels you wish to view.
- Contact your network operator for more information.

(12) If you accidentally cut the power cord, attach a new plug following the steps below. If in doubt, contact your local retailer.

- Never connect to the larger terminal marked with an "E", the safety earth symbol " \perp " or coloured green or green-and-yellow.
- The wires in the mains lead on this product are coloured with the following code:
 - Blue: Neutral wire (connect to the black terminal, or one marked "N")
 - Brown: Live wire (connect to the red terminal, or one marked "L")

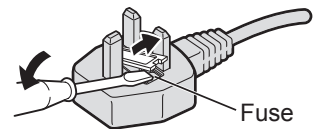

(13) Change the fuse in the plug

- Open the plug as illustrated on the right.
- When replacing the fuse, always use a correctly rated and approved type and re-fit the fuse cover when finished.

If in doubt, contact your local retailer.

(14) Cannot record programmes.

- The hard disk is full. Delete unnecessary programmes and make space for new recording.
- Check if recording is overlapped with another channel. Stop the current recording or wait until the recording is finished.

(15) Cannot operate the TSR (Time Shifted Recording).

- The TSR may not be available during the recording. Wait until the recording is finished.
- Delete unnecessary programmes and make space for new recording.

(16) The product makes a humming noise.

- The noise is from the fan; the hard disk is operating normally. This kind of noise is inevitable but seldom noticeable.

(17) Cannot playback.

- To play back the recorded file of a scrambled channel, use the Smartcard. In case it has been a long time since you last recorded, this may not work. Contact the product distributor.
- The signal during the recording may be weak or the hard disk too full.

(18) Cannot change channel while recording.

- Certain channels may not be changed due to restriction of the tuner type.

(19) How can I receive new channels?

- To receive new channels please perform an Auto search in the Installation menu and they will be added to the channel list, please refer to the Installation section. If channels change position you will need to carry out a Default Setting in the Installation menu. The TV will then restart and search for the channels again.

Important: When you carry out a Default setting, no information on your HDD (recordings) will be removed. You will need to setup any schedules and any Favourites list you have created.

(20) The Installation menu is greyed out when I access the menu.

- It is not possible to access the Installation menu when you are playing back a recording or when a recording is in progress. You will need to stop the playback/recording to access the menu.

(21) I am unable to access the EPG when I am playing back a recording

- The EPG is not available when playing a recording, stop the recording and go to a live TV channel where you will be able to access the EPG.

Error Message

Error message	Possible causes	What to do
No or Bad Signal	The aerial is not pointing properly.	Adjust aerial. Check the cable from the aerial. If you cannot resolve the problem, you may need to have your aerial and installation tested by a professional.
The channel is scrambled or not available.	The channel has a signal, but no audio or video is provided.	Confirm if the channel is currently on air.
	The channel is for data broadcasting.	The channel cannot be viewed without the appropriate model that supports data channels.
	Viewing Card is not plugged in.	Insert Viewing Card.
	Wrong Viewing Card is in use.	Insert the appropriate Viewing Card for the channel(s) you wish to view.
	Viewing Card is not plugged in correctly.	Reinsert Viewing Card; ensure that it is inserted correctly.
	Viewing Card is damaged.	Contact your Viewing Card retailer or channel broadcaster for a Viewing Card replacement.
Audio not available	The channel has a video signal, but no audio is provided.	Press the VOL+/- button on your remote control to confirm that the channel has audio options.
CAM (Conditional Access Module) not installed.	CAM (Conditional Access Module) is not installed.	Insert CAM (Conditional Access Module).
	CAM (Conditional Access Module) is not inserted correctly	Reinsert CAM (Conditional Access Module).
	CAM (Conditional Access Module) is not recognized.	Insert a different CAM (Conditional Access Module) to check if your existing module is working.
Invalid CAM (Conditional Access Module)	Wrong CAM (Conditional Access Module).	Insert the correct CAM (Conditional Access Module).
	CAM (Conditional Access Module) is not inserted correctly.	Remove and reinsert the CAM (Conditional Access Module).
	CAM (Conditional Access Module) is damaged	Replace CAM (Conditional Access Module).

Specifications

Model		LT-26DE9BJ	LT-32DE9BJ
Broadcasting systems		CCIR B/G/I/D/K/L	
Colour systems		PAL, B/G, D/K, I SECAM, B/G, D/K, L	
Channel and frequencies		Digital : 474 MHz ~ 858 MHz Analogue : 45.25 MHz ~ 855.25 MHz Cable TV (S1-S20/S21-S41)	
Sound-multiplex systems		A2 / Nicam Stereo	
Teletext systems		FLOF (Fastext), TOP	
Power requirements		AC 220 V - 240 V, 50/60 Hz	
Audio output (Rated power output)		5W + 5W	10W + 10W
Speaker size (H x W x D: mm)		(35 x 115 x 32.1) oval x 2	(40 x 200 x 45.3) oval x 2
Power consumption [standby]		105W (Max.) [0.9W]	145W (Max.) [0.9W]
Screen size (visible area size measured diagonally)		66cm	81cm
Dimensions (W x H x D: mm) [without stand]		660 x 482.5 x 200 [660 x 440 x 90]	791 x 567.5 x 230 [791 x 520.5 x 103.9]
Weights [without stand]		11.0 kg [9.5 kg]	15.1 kg [13.5 kg]
Accessories		Remote control unit × 1 (RM-C2111B) AA/R6 dry cell battery × 2	
HDD		160GB	
Input / Output	Euroconnector	EXT-1, EXT-2	EXT-1, EXT-2
		- Video input, Audio L/R inputs and RGB inputs are available. - TV broadcast outputs (Video and Audio L/R) are available. - Video and Audio L/R outputs are available. (EXT-2)	
	RCA connectors × 5 (Component)	EXT-3	EXT-3
		- Component video(Pr,Pb,Y) inputs and Audio L/R inputs are available. - 576i(625i),576p(625p),480i(525i),480p(525p),720p(750p),1080i(1125i) signals are available.	
	RCA connectors × 3 (Composite)	EXT-4	EXT-4
		- Video input and Audio L/R inputs are available.	
	S-VIDEO connector × 1 RCA connectors × 2	EXT-4S	EXT-4S
		- S-VIDEO (Y/C) input and Audio L/R inputs are available. - Audio L/R inputs are shared with Composite video terminal.	
HDMI connector	EXT-5, EXT-6	EXT-5, EXT-6, EXT-7	
	- Video input and Audio Input of the high-definition signals are available. - 576i(625i),576p(625p),480i(525i),480p(525p),720p(750p),1080i(1125i) signals are available. - All HDMI inputs support DVI video but only first HDMI input (EXT-5) supports DVI audio through component audio input (EXT-3).		
OPTICAL connector	DIGITAL AUDIO OUT (OPTICAL)		
Stereo mini jack (3.5 mm diameter)	Headphone		



JVC

For users in the UK :

If you have any problems setting up your new TV, please call the **JVC** Helpline on **0870 330 5000**.

For users in the Republic of Ireland :

If you have any problems setting up your new TV, please call the **JVC** Helpline on **1890-582500**.